

MAR 31 2026

Complaint Against the Valuation of Real Property

Answer all questions and type or print all information. Read instructions on back before completing form.
HILLARY HAMILTON
AUDITOR Attach additional pages if necessary.

This form is for full market value complaints only. All other complaints should use DTE Form 2

Original complaint Counter complaint

Notices will be sent only to those named below.

	Name	Street address, City, State, ZIP code	
1. Owner of property	The Community Gardens L.P.	Bauernschmidt Law Firm PO Box 26437 Cleveland, OH 44126-0437	
2. Complainant if not owner	Owner		
3. Complainant's agent	Karen H Bauernschmidt and Kelly Bauernschmidt	Bauernschmidt Law Firm PO Box 26437 Cleveland, OH 44126-0437	
4. Telephone number and email address of contact person (216) 702-6064 Karen@khbtaxlaw.com and Kelly@khbtaxlaw.com			
5. Complainant's relationship to property, if not owner <u>Owner</u>			
If more than one parcel is included, see "Multiple Parcels" Instruction.			
6. Parcel numbers from tax bill		Address of property	
3400700022206060		330 S Burnett Road, Springfield, Ohio	
34007000222061060		330 S Burnett Road, Springfield, Ohio	
7. Principal use of property. <u>Rent Restricted Apartments - Affordable Housing</u>			
8. The increase or decrease in market value sought. Counter-complaints supporting auditor's value may have -0- in Column C.			
Parcel number	Column A Complainant's Opinion of Value (Full Market Value)	Column B Current Value (Full Market Value)	Column C Change in Value
3400700022206060	\$195,000	\$817,190	-\$622,190
34007000222061060	\$1,031,000	\$4,307,550	-\$3,276,550
Totals	\$1,226,000	\$5,124,740	-\$3,898,740
9. The requested change in value is justified for the following reasons: <u>Income Approach to Value</u>			

10. Was property sold within the last three years? Yes No Unknown If yes, show date of sale _____

and sale price \$ _____ ; and attach information explained in "Instructions for Line 10" on back.

11. If property was not sold but was listed for sale in the last three years, attach a copy of listing agreement or other available evidence.

12. If any improvements were completed in the last three years, show date N/A and total cost N/A.

13. Do you intend to present the testimony or report of a professional appraiser? Yes No Unknown

14. If you have filed a prior complaint on this parcel since the last reappraisal or update of property values in the county, the reason for the valuation change requested must be one of those below. Please check all that apply and explain on attached sheet. See R.C. section 5715.19(A)(2) for a complete explanation. N/A

- The property was sold in an arm's length transaction
- A substantial improvement was added to the property.
- The property lost value due to a casualty.
- Occupancy change of at least 15% had a substantial economic impact on my property.

15. If the complainant is a legislative authority and the complaint is an original complaint with respect to property not owned by the complainant, R.C. 5715.19(A)(8) requires this section to be completed. **NOT APPLICABLE TO PROPERTY OWNERS.**

- The complainant has complied with the requirements of R.C. section 5715.19(A)(6)(b) and (7) and provided notice prior to the adoption of the resolution required by division (A)(6)(b) of that section as required by division (A)(7) of that section.

I declare under penalties of perjury that this complaint (including any attachments) has been examined by me and to the best of my knowledge and belief is true, correct and complete.

03/31/2026 01:02 PM EDT

Date _____ Complainant or agent (printed) Karen Bauernschmidt (6774) and Kelly Bauernschmidt (99661)
Title (if agent) Attorneys

Complainant or agent (signature) *Kelly Bauernschmidt* 

03/31/2026 01:05 PM EDT

Sworn to and signed in my presence, on _____

Notary *Jennifer Hardy* 



Jennifer Hardy
Comm Expires 11/13/2026

arial act
io/video

NiX®

3400700022206060



Hillary Hamilton
 County Auditor
 Clark County, Ohio
 clarkcountyauditor.org

3/31/2026

FIRST SKETCH **LEGAL**

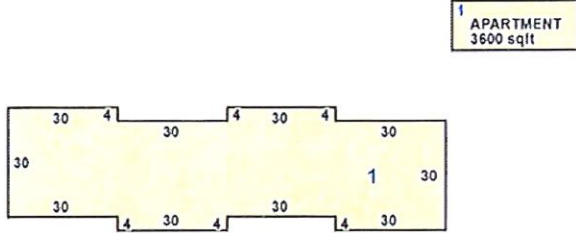

OWNER COMMUNITY GARDENS LP
 ADDRESS 330 S BURNETT RD SPRINGFIELD OH 45505
 DESCRIPTION GRANDVIEW PT 11020 & 11021
 ACREAGE 6.7000
 TAX DIST 340
 SCHOOL DIST SPRINGFIELD CSD

VALUATION		
TYPE	APPRAISED	ASSESSED
LAND	\$817,190.00	\$286,020.00
IMPROVEMENTS	\$0.00	\$0.00
CAUV	\$0.00	\$0.00
TOTAL	\$817,190.00	\$286,020.00

TAXES

TAXABLE VALUE	\$286,020.00
ROLLBACKS	NONE
HALF (1ST / 2ND)	\$8,926.03 / \$8,926.03
YEAR (TOTAL / BALANCE)	\$17,852.06 / \$8,926.03

SPECIAL ASSESSMENTS

COUNT	0
DELINQUENT / BALANCE	\$0.00 / \$0.00
TOTAL / BALANCE	\$0.00 / \$0.00

LAND

CODE	FRONTAGE	DEPTH	ACREAGE	SQFT	VALUE
SQUARE FOOT	73	201	6.700	291,852	\$817,190.00
Unknown					

IMPROVEMENTS

DESCRIPTION	BUILT	DIMS	VALUE
(RG1) - FRAME OR CONCRETE BLOCK DETACHED GARAGE	2018	20x21	\$0.00

MOST RECENT SALES

DATE	BUYER	SELLER	# PARCELS	PRICE	VALIDITY
8/18/2017	COMMUNITY GARDENS LP	NEIGHBORHOOD HOUSING PARTNERSHIP OF	0	\$100,000.00	Unknown

34007000222061060



Hillary Hamilton
 County Auditor
 Clark County, Ohio
 clarkcountyauditor.org

3/31/2026

FIRST SKETCH **LEGAL**

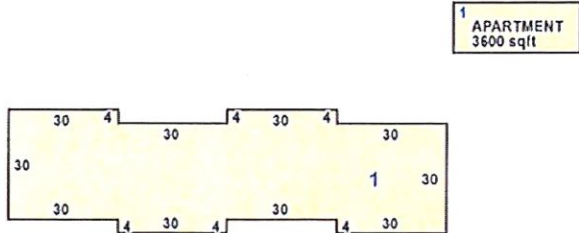

OWNER COMMUNITY GARDENS LP
 ADDRESS 330 S BURNETT RD SPRINGFIELD OH 45505
 DESCRIPTION GRANDVIEW PT 11020 & 11021
 ACREAGE 6.7000
 TAX DIST 340
 SCHOOL DIST SPRINGFIELD CSD

VALUATION		
TYPE	APPRAISED	ASSESSED
LAND	\$0.00	\$0.00
IMPROVEMENTS	\$4,307,550.00	\$1,507,640.00
CAUV	\$0.00	\$0.00
TOTAL	\$4,307,550.00	\$1,507,640.00

TAXES

TAXABLE VALUE	\$1,507,640.00
ROLLBACKS	NONE
HALF (1ST / 2ND)	\$0.00 / \$0.00
YEAR (TOTAL / BALANCE)	\$0.00 / \$0.00

SPECIAL ASSESSMENTS

COUNT	0
DELINQUENT / BALANCE	\$0.00 / \$0.00
TOTAL / BALANCE	\$0.00 / \$0.00

LAND

IMPROVEMENTS

DESCRIPTION	BUILT	DIMS	VALUE
(RG1) - FRAME OR CONCRETE BLOCK	2018	20x21	\$12,410.00
DETACHED GARAGE			

MOST RECENT SALES

DATE	BUYER	SELLER	# PARCELS	PRICE	VALIDITY
8/18/2017	COMMUNITY GARDENS LP	NEIGHBORHOOD HOUSING PARTNERSHIP OF	0	\$100,000.00	Unknown
8/18/2017	COMMUNITY GARDENS LP	NEIGHBORHOOD HOUSING PARTNERSHIP OF	0	\$100,000.00	Unknown

COMMERCIAL PROPERTY RECORD CARD

CLARK COUNTY

Situs : 330 S BURNETT RD Map ID: 340-07-00022-206-060 LUC: 403-APARTMENTS 40 OR MORE REI Card: 1 of 5 Tax Year: 2025 Printed: 04/01/26

CURRENT OWNER	GENERAL INFORMATION
COMMUNITY GARDENS LP	Routing No. 0022-03 037-00 Class C-Commercial Living Units 50 Neighborhood 340C1000 Alternate Id District Zoning CAUV
Field Review Flag:	

Property Notes
 ABATEMENT (2019-2033) 100% BLDG ONLY
 TY19NC-NEW APT BLDGS 100% COMPLETE Note Codes:
 AB-Abatement

Type	Rate	Size	Influence Factors	Infl %	Value
1-Primary Site	SF	2.8	291.85		817,190
Total Acres: 6.7					Legal Acres: 6.7

Date	ID	Entry Code	Source
04/23/24	STP	10-Adv	3-Other
06/06/19	KAR	2-Information At Door	4-Employee
06/01/18	KAR	2-Information At Door	3-Other



Assessment Information					
	Assessed	Appraised	Cost	Income	Market
Land	286,020	817,190	817,190	0	0
Building	0	0	0	0	0
Total	286,020	817,190	817,190	0	0
Value Flag 1-COST APPROACH Manual Override Reason Base Date of Value Effective Date of Value					

Date Issued	Number	Price Purpose	Note	Status
06/28/17		NEW HOME	13 Permits For New Dwellings/MClosed Permit	

Sales/Ownership History			
Transfer Date	Price	Type	Validity
08/18/17	100,000		

Property Factors
 Topo: 2-Above Street
 Utilities: 1-All Public
 Street/Road: 1-Paved 5-Sidewalk
 Traffic: 3-Heavy
 Location:
 Spot Loc:

Legal Description
 Parcel TieBack: 34007000222061060 Addl. TieBack:
 Range - Township - Section: - - -
 Legal Descriptions: GRANDVIEW PT 11020 & 11021
 PT NE 1/4

COMMERCIAL PROPERTY RECORD CARD

CLARK COUNTY

Situs : 330 S BURNETT RD

Parcel Id: 340-07-00022-206-060

LUC: 403-APARTMENTS 40 OR MORE REN

Card: 1 of 5

Tax Year: 2025

Printed: 04/01/26

Building Information	
Year Built/Est Year	2018 /
Building #	1
Structure Type	211-Apartments - G:
Identical Units	1
Total Units	4
Grade	C
# Covered Parking	
# Uncovered Parking	
DBA	UNITS 101-104

Building Other Features											
Line Type	+/-	Meas1	Meas2	# Stp	IU	Line Type	+/-	Meas1	Meas2	# Stp	IU
1	RA1-Garage-Attached-Fri	14	22	4	4						
1	PR1-Porch, Open	7	17	2	2						
1	PR1-Porch, Open	192	1	2	2						

Interior/Exterior Information																
Line	Lvl	Fr - To	Area	Perim	Use Type	Wall Height	Ext Walls	Construction	Int Fin	Partitions	Heating	Cooling	Plumbing	Phy Fun	%Comp	%Rent
1	01	01	3,600	324	011-Apartment	9	02-Frame	1-Wood Frame	100	2-Normal	2-Normal	1-Central	2-Normal	3	3	

Interior/Exterior Valuation Detail					
Line	Area	Use Type	% Good	% Comp	Use Value/RCNLD
1	3,600	011-Apartment	91		343,600

Outbuilding Data											
Line	Type	Yr Bld	Meas1	Meas2	Area Gr	Qty	ModCd	Phy Fun	MA	%Comp	Value
1	RG1-Det Garage	2018	20	21	420	C	1	G	G	0	

COMMERCIAL PROPERTY RECORD CARD

CLARK COUNTY

Situs : 330 S BURNETT RD Parcel Id: 340-07-00022-206-060 LUC: 403-APARTMENTS 40 OR MORE REN Card: 1 of 5 Tax Year: 2025 Printed: 04/01/26

Income Detail (Includes all Buildings on Parcel)

Use Mod Grp Type	Inc Mod Description	Units	Net Area	Income Rate	Econ Adjust	Potential Gross Income	Vac Model	Vac Adj	Additional Income	Effective Gross Income	Expense Model %	Expense Adj %	Expense Adj	Other Expenses	Total Expenses	Net Operating Income
01 A	133 01-Apartment Unit	0	45,000				5		0							35

Line	Use Type	Per Bldg	Beds	Baths	Other	Units	Rent	Income
------	----------	----------	------	-------	-------	-------	------	--------

Apartment Detail - Building 1 of 5

Building Cost Detail - Building 1 of 5	
Total Gross Building Area	3,600
Replace, Cost New Less Depr	343,600
Percent Complete	0
Number of Identical Units	1
Economic Condition Factor	
Final Building Value	1,0000
NBHD Fact	
Value per SF	0.00

Notes - Building 1 of 5

Income Summary (Includes all Building on Parcel)

Total Gross Rent Area	45,000
Total Gross Building Area	45,000

Misc & Gross Bulding Values

Misc Building No	
Gross Building:	Misc Adjusted Value

COMMERCIAL PROPERTY RECORD CARD

CLARK COUNTY

Situs : 330 S BURNETT RD

Map ID: 340-07-00022-206-060

LUC: 403-APARTMENTS 40 OR MORE REN

Card: 2 of 5

Tax Year: 2025

Printed: 04/01/26

CURRENT OWNER	GENERAL INFORMATION
COMMUNITY GARDENS LP	Routing No. 0022-03 037-00 Class C-Commercial Living Units 50 Neighborhood 340C:1000 Alternate Id District Zoning CAUV
Field Review Flag:	

ABATEMENT (2019-2033) 100% BLDG ONLY
TY19NC-NEW APT BLDGS 100% COMPLETE

Note Codes:
AB-Abatement



Land Information				
Type	Rate	Size	Influence Factors	Value
1-Primary Site SF	2.8	291.85		817,190
Total Acres: 6.7				
Legal Acres: 6.7				

Assessment Information					
	Assessed	Appraised	Cost	Income	Market
Land	286,020	817,190	817,190	0	0
Building	0	0	0	0	0
Total	286,020	817,190	817,190	0	0
Value Flag 1-COST APPROACH					
Manual Override Reason					
Base Date of Value					
Effective Date of Value					

Entrance Information			
Date	ID	Entry Code	Source
04/23/24	STP	10-Adv	3-Other
06/06/19	KAR	2-Information At Door	4-Employee
06/01/18	KAR	2-Information At Door	3-Other

Permit Information			
Date Issued	Number	Price Purpose	Note
06/28/17		NEW HOME	13 Permits For New Dwellings/M/Closed Permit

Sales/Ownership History			
Transfer Date	Price	Type	Validity
08/18/17	100,000		

Deed Reference			
Deed Reference	Deed Type	Grantor	
WD-General Warranty Deed		NEIGHBORHOOD HOUSING PARTNERSH	

Property Factors	
Topo: 2-Above Street	
Utilities: 1-All Public	
Street/Road: 1-Paved	5-Sidewalk
Traffic: 3-Heavy	
Location:	
Spot Loc:	

Legal Description	
Parcel TieBack: 34007000222061060	Addl.TieBack:
Range - Township - Section: - - -	
Legal Descriptions:	
GRANDVIEW PT 11020 & 11021	
PT NE 1/4	

COMMERCIAL PROPERTY RECORD CARD

CLARK COUNTY

Stitus : 330 S BURNETT RD

Parcel Id: 340-07-00022-206-060

LUC: 403-APARTMENTS 40 OR MORE REN

Card: 2 of 5

Tax Year: 2025

Printed: 04/01/26

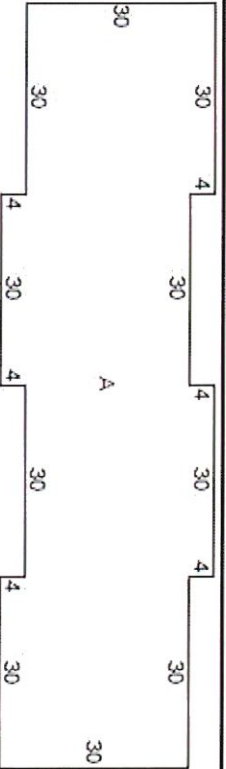

ID	Code	Description	Area
A	011	APARTMENT	3600
B	RA1	GARAGE-ATTACHED-FRM	308*
C	PR1	PORCH, OPEN	119*
D	PR1	PORCH, OPEN	192*

Additional Property Photos



COMMERCIAL PROPERTY RECORD CARD

CLARK COUNTY

Situs : 330 S BURNETT RD

Parcel Id: 340-07-00022-206-060

LUC: 403-APARTMENTS 40 OR MORE REN

Card: 2 of 5

Tax Year: 2025

Printed: 04/01/26

Income Detail (Includes all Buildings on Parcel)

Use Mod Grp Type	Inc Mod Description	Units	Net Area	Income Rate	Econ Adjust	Potential Gross Income	Vac Model	Vac Adj	Additional Income	Effective Gross Income	Expense Model %	Expense Adj %	Expense Adj	Other Expenses	Total Expenses	Net Operating Income
01 A	133 01-Apartment Unit	0	45,000				5		0							35

Apartment Detail - Building 2 of 5

Line	Use Type	Per Bldg	Beds	Baths	Other	Units	Rent	Income
------	----------	----------	------	-------	-------	-------	------	--------

Building Cost Detail - Building 2 of 5

Total Gross Building Area	3,600
Replace, Cost New Less Depr	344,770
Percent Complete	0
Number of Identical Units	1
Economic Condition Factor	
Final Building Value	1,0000
NBHD Fact	
Value per SF	0.00

Notes - Building 2 of 5

Income Summary (Includes all Building on Parcel)

Total Gross Rent Area	45,000
Total Gross Building Area	45,000

Misc & Gross Building Values

Misc Building No	
Gross Building:	Misc Adjusted Value

COMMERCIAL PROPERTY RECORD CARD

CLARK COUNTY

Situs : 330 S BURNETT RD Map ID: 340-07-00022-206-060 LUC: 403-APARTMENTS 40 OR MORE REN Card: 3 of 5 Tax Year: 2025 Printed: 04/01/26

CURRENT OWNER	GENERAL INFORMATION
COMMUNITY GARDENS LP	Routing No. 0022-03 037-00 Class C-Commercial Living Units 50 Neighborhood 340C-1000 Alternate Id District Zoning CAUV
Field Review Flag:	

Property Notes
 ABATEMENT (2019-2033) 100% BLDG ONLY
 TY19NC-NEW APT BLDGS 100% COMPLETE
 Note Codes:
 AB-Abatement



Land Information				
Type	Rate	Size	Influence Factors	Value
1-Primary Site	SF	2.8	291.85	817,190
Total Acres: 6.7 Legal Acres: 6.7				

Assessment Information					
	Assessed	Appraised	Cost	Income	Market
Land	286,020	817,190	817,190	0	0
Building	0	0	0	0	0
Total	286,020	817,190	817,190	0	0
Value Flag 1-COST APPROACH Manual Override Reason Base Date of Value Effective Date of Value					

Entrance Information			
Date	ID	Entry Code	Source
04/23/24	STP	10-Adv	3-Other
06/06/19	KAR	2-Information At Door	4-Employee
06/01/18	KAR	2-Information At Door	3-Other

Permit Information			
Date Issued	Number	Price Purpose	Note
06/28/17		NEW HOME	13 Permits For New Dwellings/M/Closed Permit

Sales/Ownership History			
Transfer Date	Price	Type	Validity
08/18/17	100,000		

Deed Reference			
Deed Reference	Deed Type	Grantor	
WD-General Warranty Deed		NEIGHBORHOOD HOUSING PARTNERSH	

Property Factors
 Topo: 2-Above Street
 Utilities: 1-All Public
 Street/Road: 1-Paved 5-Sidewalk
 Traffic: 3-Heavy
 Location:
 Spot Loc:

Legal Description
 Parcel TieBack: 340070000222061060 Addl.TieBack:
 Range - Township - Section: - - -
 Legal Descriptions:
 GRANDVIEW PT 11020 & 11021
 PT NE 1/4

COMMERCIAL PROPERTY RECORD CARD

CLARK COUNTY

Situs : 330 S BURNETT RD

Parcel Id: 340-07-00022-206-060

LUC: 403-APARTMENTS 40 OR MORE REN

Card: 3 of 5

Tax Year: 2025

Printed: 04/01/26

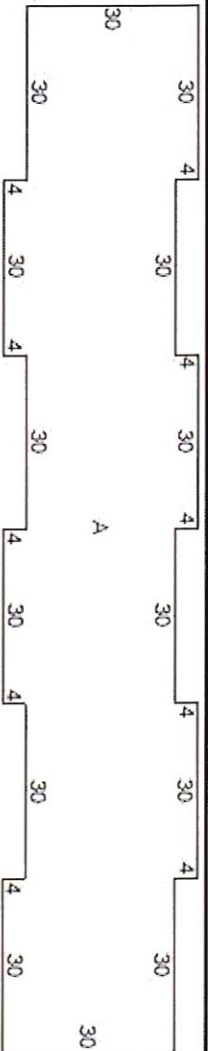

ID	Code	Description	Area
A	011	APARTMENT	5400
B	R41	GARAGE-ATTACHED-FRM	308*
C	PR1	PORCH, OPEN	119*
D	PR1	PORCH, OPEN	192*

Additional Property Photos



COMMERCIAL PROPERTY RECORD CARD

CLARK COUNTY

Situs : 330 S BURNETT RD Parcel Id: 340-07-00022-206-060 LUC: 403-APARTMENTS 40 OR MORE REN Card: 3 of 5 Tax Year: 2025 Printed: 04/01/26

Income Detail (Includes all Buildings on Parcel)

Use Mod Grp Type	Inc Mod Description	Units	Net Area	Income Rate	Econ Adjust	Potential Gross Income	Vac Model	Vac Adj	Additional Income	Effective Gross Income	Expense Model %	Expense Adj %	Expense Adj	Other Expenses	Total Expenses	Net Operating Income
01 A	133 01-Apartment Unit	0	45,000				5		0							35

Apartment Detail - Building 3 of 5

Line	Use Type	Per Bldg	Beds	Baths	Other	Units	Rent	Income

Building Cost Detail - Building 3 of 5

Total Gross Building Area	21,600
Replace, Cost New Less Depr	510,940
Percent Complete	0
Number of Identical Units	4
Economic Condition Factor	
Final Building Value	1.0000
NBHD Fact	
Value per SF	0.00

Notes - Building 3 of 5

Income Summary (Includes all Building on Parcel)

Total Gross Rent Area	45,000
Total Gross Building Area	45,000

Misc & Gross Building Values

Misc Building No
Gross Building:
Misc Adjusted Value

COMMERCIAL PROPERTY RECORD CARD

CLARK COUNTY

Situs : 330 S BURNETT RD Map ID: 340-07-00022-206-060 LUC: 403-APARTMENTS 40 OR MORE REN Card: 4 of 5 Tax Year: 2025 Printed: 04/01/26

CURRENT OWNER	GENERAL INFORMATION
COMMUNITY GARDENS LP	Routing No. 0022-03 037-00 Class C-Commercial Living Units 50 Neighborhood 340C-1000 Alternate Id District Zoning CALV
Field Review Flag:	

Property Notes
 ABATEMENT (2019-2033) 100% BLDG ONLY
 TY19NC-NEW APT BLDGS 100% COMPLETE
 Note Codes: AB-Abatement



Land Information					
Type	Rate	Size	Influence Factors	Infl %	Value
1-Primary Site	SF	2.8	291.85		817,190
Total Acres: 6.7					Legal Acres: 6.7

Assessment Information					
	Assessed	Appraised	Cost	Income	Market
Land	286,020	817,190	817,190	0	0
Building	0	0	0	0	0
Total	286,020	817,190	817,190	0	0

Value Flag 1-COST APPROACH Manual Override Reason
 Base Date of Value
 Effective Date of Value

Entrance Information			
Date	ID	Entry Code	Source
04/23/24	STP	10-Adv	3-Other
06/06/19	KAR	2-Information At Door	4-Employee
06/01/18	KAR	2-Information At Door	3-Other

Permit Information				
Date Issued	Number	Price Purpose	Note	Status
06/28/17			NEW HOME	13 Permits For New Dwellings/MClosed Permit

Sales/Ownership History			
Transfer Date	Price	Type	Validity
08/18/17	100,000		

Deed Reference			
Deed Reference	Deed Type	Grantor	
WD-General Warranty Deed		NEIGHBORHOOD HOUSING PARTNERSH	

Property Factors
 Topo: 2-Above Street
 Utilities: 1-All Public
 Street/Road: 1-Paved
 Traffic: 3-Heavy
 Location:
 Spot Loc:

Legal Description
 Parcel TieBack: 34007000222061060
 Range - Township - Section: - -
 Legal Descriptions:
 GRANDVIEW PT 11020 & 11021
 PT NE 1/4
 Addl. TieBack:

COMMERCIAL PROPERTY RECORD CARD

CLARK COUNTY

Situs : 330 S BURNETT RD

Parcel Id: 340-07-00022-206-060

LUC: 403-APARTMENTS 40 OR MORE REN

Card: 4 of 5

Tax Year: 2025

Printed: 04/01/26

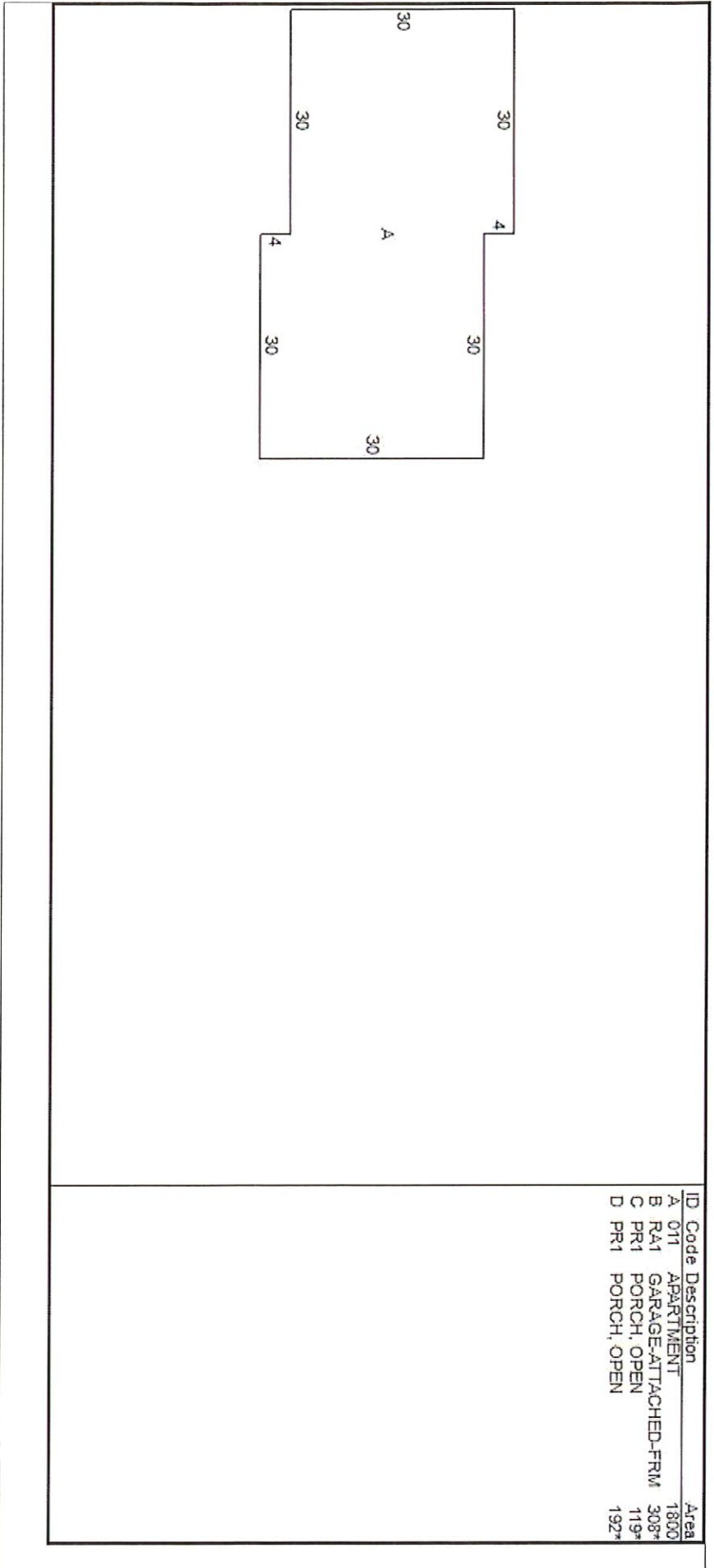

Additional Property Photos



COMMERCIAL PROPERTY RECORD CARD

CLARK COUNTY

Situs : 330 S BURNETT RD Parcel Id: 340-07-00022-206-060 LUC: 403-APARTMENTS.40 OR MORE REP Card: 4 of 5 Tax Year: 2025 Printed: 04/01/26

Income Detail (Includes all Buildings on Parcel)

Use Mod Grp	Inc Type	Mod Description	Units	Net Area	Income Rate	Econ Adjust	Potential Gross Income	Vac Model	Vac Adj	Additional Income	Effective Gross Income	Expense Model %	Expense Adj %	Expense Adj	Other Expenses	Total Expenses	Net Operating Income
01	A	133	01-Apartment Unit	0	45,000			5		0							35

Apartment Detail - Building 4 of 5

Line	Use Type	Per Bldg	Beds	Baths	Other	Units	Rent	Income
------	----------	----------	------	-------	-------	-------	------	--------

Building Cost Detail - Building 4 of 5

Total Gross Building Area	5,400
Replace, Cost New Less Depr	174,430
Percent Complete	0
Number of Identical Units	3
Economic Condition Factor	
Final Building Value	1.0000
NBHD Fact	
Value per SF	0.00

Notes - Building 4 of 5

Income Summary (Includes all Building on Parcel)

Total Gross Rent Area	45,000
Total Gross Building Area	45,000

Misc & Gross Building Values

Misc Building No
Gross Building:
Misc Adjusted Value

COMMERCIAL PROPERTY RECORD CARD

CLARK COUNTY

Situs : 330 S BURNETT RD Map ID: 340-07-00022-206-060 LUC: 403-APARTMENTS 40 OR MORE REN Card: 5 of 5 Tax Year: 2025 Printed: 04/01/26

CURRENT OWNER	GENERAL INFORMATION
COMMUNITY GARDENS LP	Routing No. 0022-03 037-00 Class C-Commercial Living Units 50 Neighborhood 340C1000 Alternate Id District Zoning CAUV
Field Review Flag:	

Property Notes
 ABATEMENT (2019-2033) 100% BLDG ONLY
 TY19NC-NEW APT BLDGS 100% COMPLETE Note Codes:
 AB-Abatement



Land Information				
Type	Rate	Size	Influence Factors	Value
1-Primary Site	SF	2.8	291.85	817,190
Total Acres: 6.7				Legal Acres: 6.7

Assessment Information					
	Assessed	Appraised	Cost	Income	Market
Land	286,020	817,190	817,190	0	0
Building	0	0	0	0	0
Total	286,020	817,190	817,190	0	0

Value Flag 1-COST APPROACH Manual Override Reason
 Base Date of Value
 Effective Date of Value

Entrance Information			
Date	ID	Entry Code	Source
04/23/24	STP	10-Adv	3-Other
06/06/19	KAR	2-Information At Door	4-Employee
06/01/18	KAR	2-Information At Door	3-Other

Permit Information			
Date Issued	Number	Price Purpose	Note
06/28/17		NEW HOME	13 Permits For New Dwellings/MClosed Permit

Sales/Ownership History			
Transfer Date	Price	Type	Validity
08/18/17	100,000		

Deed Reference			Deed Type	Grantor
WD-General Warranty Deed				NEIGHBORHOOD HOUSING PARTNERSH

Property Factors
 Topo: 2-Above Street
 Utilities: 1-All Public
 Street/Road: 1-Paved 5-Sidewalk
 Traffic: 3-Heavy
 Location:
 Spot Loc:

Legal Description
 Parcel TieBack: 34007000222061060 Addl TieBack:
 Range - Township - Section: - - -
 Legal Descriptions:
 GRANDVIEW PT 11020 & 11021
 PT NE 1/4

COMMERCIAL PROPERTY RECORD CARD

CLARK COUNTY

Situs : 330 S BURNETT RD

Parcel Id: 340-07-00022-206-060

LUC: 403-APARTMENTS 40 OR MORE REN

Card: 5 of 5

Tax Year: 2025

Printed: 04/01/26

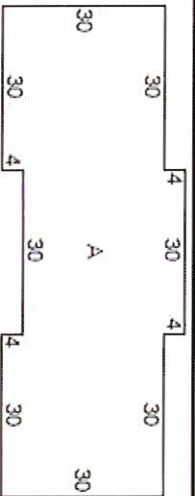

ID	Code	Description	Area
A	011	APARTMENT	2700
B	RA1	GARAGE-ATTACHED-FRM	308*
C	PR1	PORCH, OPEN	119*
D	PR1	PORCH, OPEN	192*

Additional Property Photos



COMMERCIAL PROPERTY RECORD CARD

CLARK COUNTY

Situs : 330 S BURNETT RD Parcel Id: 340-07-00022-206-060 LUC: 403-APARTMENTS 40 OR MORE REN Card: 5 of 5 Tax Year: 2025 Printed: 04/01/26

Income Detail (Includes all Buildings on Parcel)

Use Mod Grp	Inc Type	Mod Description	Units	Net Area	Income Rate	Econ Adjust	Potential Gross Income	Vac Model	Vac Adj	Additional Income	Effective Gross Income	Expense Model %	Expense Adj %	Expense Adj	Other Expenses	Total Expenses	Net Operating Income
01	A	133 01-Apartment Unit	0	45,000				5		0							35

Apartment Detail - Building 5 of 5

Line	Use Type	Per Bldg	Beds	Baths	Other	Units	Rent	Income

Building Cost Detail - Building 5 of 5

Total Gross Building Area	10,800
Replace, Cost New Less Depr	259,930
Percent Complete	0
Number of Identical Units	4
Economic Condition Factor	
Final Building Value	1,0000
NBHD Fact	
Value per SF	0.00

Notes - Building 5 of 5

Income Summary (Includes all Building on Parcel)

Total Gross Rent Area	45,000
Total Gross Building Area	45,000

Misc & Gross Building Values

Misc Building No
Gross Building:
Misc Adjusted Value

COMMERCIAL PROPERTY RECORD CARD

CLARK COUNTY

Situs : 330 S BURNETT RD Map ID: 340-07-00022-206-1060 LUC: 710-SECTION 3735.67 - CRA Card: 1 of 5 Tax Year: 2025 Printed: 04/01/26

CURRENT OWNER	GENERAL INFORMATION
COMMUNITY GARDENS LP	Routing No. 0022-03 037-00 Class E Living Units 50 Neighborhood 340C-1000 Alternate Id District Zoning CAUV
Field Review Flag:	

Property Notes
 ABATEMENT (2019-2033) 100% BLDG ONLY Note Codes:
 TY19NC-NEW APT BLDGS 100% COMPLETE AB-Abatement

Type	Rate	Size	Influence Factors	Infl %	Value
Total Acres: Legal Acres: 6.7					

Date	ID	Entry Code	Source
06/06/19	KAR	2-Information At Door	4-Employee
06/01/18	KAR	2-Information At Door	3-Other

Assessment Information					
	Assessed	Appraised	Cost	Income	Market
Land	0	0	0	0	0
Building	1,507,640	4,307,550	4,307,550	0	0
Total	1,507,640	4,307,550	4,307,550	0	0
Value Flag	1-COST APPROACH Manual Override Reason Base Date of Value Effective Date of Value				

Date Issued	Number	Price	Purpose	Note	Status
06/28/17			NEW HOME	13 Permits For New Dwellings/MClosed Permit	

Transfer Date	Price	Type	Validity	Sales/Ownership History	Deed Reference	Deed Type	Grantor
08/18/17	100,000						NEIGHBORHOOD HOUSING PARTNERSH
08/18/17	100,000						WD-General Warranty Deed NEIGHBORHOOD HOUSING PARTNERSH

Property Factors
 Topo: 2-Above Street
 Utilities: 1-All Public
 Street/Road: 1-Paved 5-Sidewalk
 Traffic: 3-Heavy
 Location:
 Spot Loc:

Legal Description
 Parcel TieBack: 3400700022206060 Addl. TieBack:
 Range - Township - Section: - -
 Legal Descriptions:
 GRANDVIEW PT 11020 & 11021
 PT NE 1/4

COMMERCIAL PROPERTY RECORD CARD

CLARK COUNTY

Status : 330 S BURNETT RD

Parcel Id: 340-07-00022-206-1060

LUC: 710-SECTION 3735.67 - CRA

Card: 1 of 5

Tax Year: 2025

Printed: 04/01/26

Building Information

Year Built/Eff Year 2018 /
 Building # 1
 Structure Type 211-Apartments - G:
 Identical Units 1
 Total Units 4
 Grade C
 # Covered Parking
 # Uncovered Parking
 DBA UNITS 101-104

Building Other Features

Line Type	+/-	Meas1	Meas2	# Stp	IU	Line Type	+/-	Meas1	Meas2	# Stp	IU
1 RA1-Garage-Attached-Frr		14	22		4						
1 PR1-Porch, Open		7	17		2						
1 PR1-Porch, Open		192		1	2						

Interior/Exterior Information

Line	Lvl	Fr - To	Area	Perim	Use Type	Wall Height	Ext Walls	Construction	Int Fin	Partitions	Heating	Cooling	Plumbing	Phy Fun	%Comp	%Rent
1	01	01	3,600	324	011-Apartment	9	02-Frame	1-Wood Frame	100	2-Normal	2-Normal	1-Central	2-Normal	3	3	

Interior/Exterior Valuation Detail

Line	Area	Use Type	% Good	% Comp	Use Value/RCNLD
1	3,600	011-Apartment	91		343,600

Outbuilding Data

Line	Type	Yr Bld	Meas1	Meas2	Area Gr	Qty	ModCd	Phy Fun	MA	%Comp	Value
1	RG1-Det Garage	2018	20	21	420	C	1	G	G		12,410

COMMERCIAL PROPERTY RECORD CARD

CLARK COUNTY

Situs : 330 S BURNETT RD

Parcel Id: 340-07-00022-206-1060

LUC: 710-SECTION 3735.67 - CRA

Card: 1 of 5

Tax Year: 2025

Printed: 04/01/26

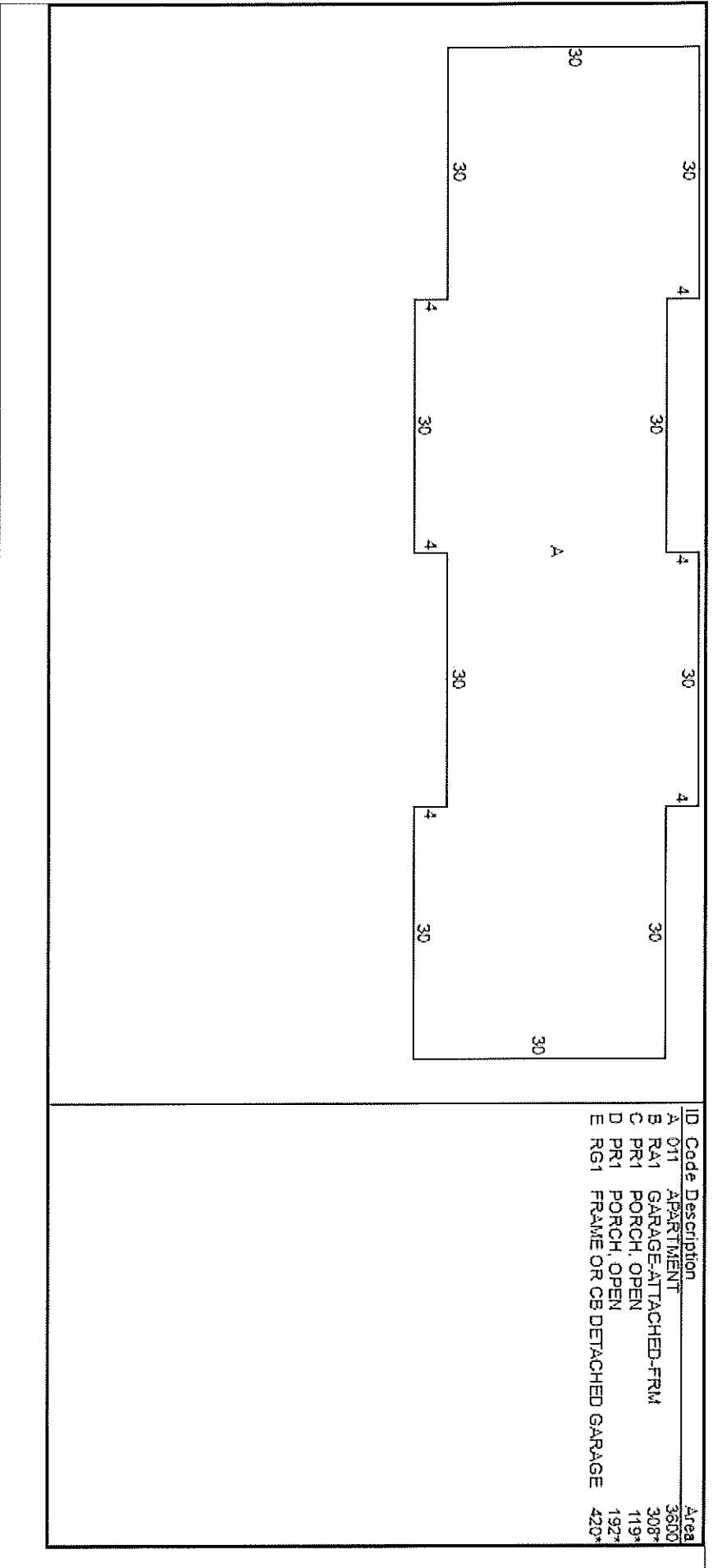

Additional Property Photos

COMMERCIAL PROPERTY RECORD CARD

CLARK COUNTY

Stitus : 330 S BURNETT RD

Parcel Id: 340-07-00022-206-1060

LUC: 710-SECTION 3735.67 - CRA

Card: 1 of 5

Tax Year: 2025

Printed: 04/01/26

Income Detail (Includes all Buildings on Parcel)

Use Mod	Inc	Model	Units	Net Area	Income Rate	Econ Adjust	Potential Gross Income	Vac Model	Vac Adj	Additional Income	Effective Gross Income	Expense Model %	Expense Adj %	Expense Adj	Other Expenses	Total Expenses	Net Operating Income
01	A	133	0	45,000				5		0							35

Apartment Detail - Building 1 of 5

Line	Use Type	Per Bldg	Beds	Baths	Other	Units	Rent	Income
------	----------	----------	------	-------	-------	-------	------	--------

Building Cost Detail - Building 1 of 5

Total Gross Building Area	3,600
Replace, Cost New Less Depr	343,600
Percent Complete	100
Number of Identical Units	1
Economic Condition Factor	343,600
Final Building Value	1,0000
NBHD Fact	
Value per SF	95.44

Notes - Building 1 of 5

Income Summary (Includes all Building on Parcel)

Total Gross Rent Area	45,000
Total Gross Building Area	45,000

Misc & Gross Building Values

Misc Building No	
Gross Building:	Misc Adjusted Value

COMMERCIAL PROPERTY RECORD CARD

CLARK COUNTY

Situs : 330 S BURNETT RD

Map ID: 340-07-00022-206-1060

LUC: 710-SECTION 3735.67 - CRA

Card: 2 of 5

Tax Year: 2025

Printed: 04/01/26

CURRENT OWNER	GENERAL INFORMATION
COMMUNITY GARDENS LP	Routing No. 0022-03 037-00 Class E Living Units 50 Neighborhood 340C1000 Alternate Id District Zoning CAUV
Field Review Flag:	

Property Notes
 ABATEMENT (2019-2033) 100% BLDG ONLY
 TY19NC-NEW APT BLDGS 100% COMPLETE
 Note Codes:
 AB-Abatement

Type	Rate	Size	Influence Factors	Infl %	Value
Land Information					
Total Acres: Legal Acres: 6.7					

Assessment Information					
	Assessed	Appraised	Cost	Income	Market
Land	0	0	0	0	0
Building	1,507,640	4,307,550	4,307,550	0	0
Total	1,507,640	4,307,550	4,307,550	0	0
Value Flag 1-COST APPROACH					
Manual Override Reason Base Date of Value Effective Date of Value					

Entrance Information			
Date	ID	Entry Code	Source
06/06/19	KAR	2-Information At Door	4-Employee
06/01/18	KAR	2-Information At Door	3-Other

Permit Information			
Date Issued	Number	Price Purpose	Note
06/28/17		NEW HOME	13 Permits For New Dwellings/MClosed Permit

Sales/Ownership History			
Transfer Date	Price	Type	Validity
08/18/17	100,000		
08/18/17	100,000		

Deed Reference			Deed Type	Grantor
			WD-General Warranty Deed	NEIGHBORHOOD HOUSING PARTNERSH NEIGHBORHOOD HOUSING PARTNERSH

Property Factors
 Topo: 2-Above Street
 Utilities: 1-All Public
 Street/Road: 1-Paved
 Traffic: 3-Heavy
 Location:
 Spot Loc:

Legal Description
 Parcel TieBack: 3400700022206060
 Range - Township - Section: - -
 Legal Descriptions:
 GRANDVIEW PT 11020 & 11021
 PT NE 1/4
 Addl.TieBack:

COMMERCIAL PROPERTY RECORD CARD

CLARK COUNTY

Situs : 330 S BURNETT RD

Parcel Id: 340-07-00022-206-1060

LUC: 710-SECTION 3735.67 - CRA

Card: 2 of 5

Tax Year: 2025

Printed: 04/01/26

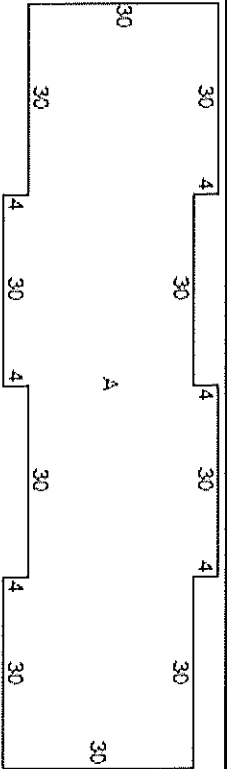

ID	Code	Description	Area
A	011	APARTMENT	3600
B	RA1	GARAGE-ATTACHED-FRM	308*
C	PR1	PORCH, OPEN	119*
D	PR1	PORCH, OPEN	192*

Additional Property Photos

COMMERCIAL PROPERTY RECORD CARD

CLARK COUNTY

Status : 330 S BURNETT RD

Parcel Id: 340-07-00022-206-1060

LUC: 710-SECTION 3735.67 - CRA

Card: 2 of 5

Tax Year: 2025

Printed: 04/01/26

Income Detail (Includes all Buildings on Parcel)

Use Mod	Inc	Model	Units	Net Area	Income Rate	Econ Adjust	Potential Gross Income	Vac Model	Vac Adj	Additional Income	Effective Gross Income	Expense Model %	Expense Adj %	Expense Adj	Other Expenses	Total Expenses	Net Operating Income
01	A	133	0	45,000				5		0							35

Apartment Detail - Building 2 of 5

Line	Use Type	Per Bldg	Beds	Baths	Other	Units	Rent	Income
------	----------	----------	------	-------	-------	-------	------	--------

Building Cost Detail - Building 2 of 5

Total Gross Building Area	3,600
Replace, Cost New Less Depr	344,770
Percent Complete	100
Number of Identical Units	1
Economic Condition Factor	
Final Building Value	344,770
NBHD Fact	1,0000
Value per SF	95.77

Notes - Building 2 of 5

Income Summary (Includes all Building on Parcel)

Total Gross Rent Area	45,000
Total Gross Building Area	45,000

Misc & Gross Building Values

Misc Building No	
Gross Building:	Misc Adjusted Value

COMMERCIAL PROPERTY RECORD CARD

CLARK COUNTY

Stitus : 330 S BURNETT RD

Map ID: 340-07-00022-206-1060

LUC: 710-SECTION 3735.67 - CRA

Card: 3 of 5

Tax Year: 2025

Printed: 04/01/26

CURRENT OWNER	GENERAL INFORMATION
COMMUNITY GARDENS LP	Routing No. 0022-03 037-00 Class E Living Units 50 Neighborhood 340C:1000 Alternate Id District Zoning CAUV
Field Review Flag:	

Property Notes
 ABATEMENT (2019-2033) 100% BLDG ONLY
 TY19NC-NEW APT BLDGS 100% COMPLETE
 Note Codes:
 AB-Abatement

Type	Rate	Size	Influence Factors	Infl %	Value
Land Information					
Total Acres: Legal Acres: 6.7					

Assessment Information					
	Assessed	Appraised	Cost	Income	Market
Land	0	0	0	0	0
Building	1,507,640	4,307,550	4,307,550	0	0
Total	1,507,640	4,307,550	4,307,550	0	0
Value Flag 1-COST APPROACH Manual Override Reason Base Date of Value Effective Date of Value					

Entrance Information			
Date	ID	Entry Code	Source
06/06/19	KAR	2-Information At Door	4-Employee
06/01/18	KAR	2-Information At Door	3-Other

Permit Information			
Date Issued	Number	Price Purpose	Note
06/28/17		NEW HOME	13 Permits For New Dwellings/M/Closed Permit

Sales/Ownership History			
Transfer Date	Price	Type	Validity
08/18/17	100,000		
08/18/17	100,000		

Deed Reference			Deed Type	Grantor
			WD-General Warranty Deec	NEIGHBORHOOD HOUSING PARTNERSH NEIGHBORHOOD HOUSING PARTNERSH

Property Factors
 Topo: 2-Above Street
 Utilities: 1-All Public
 Street/Road: 1-Paved
 Traffic: 3-Heavy
 Location:
 Spot Loc:

Legal Description
 Parcel TieBack: 3400700022206060
 Range - Township - Section: - -
 Legal Descriptions:
 GRANDVIEW PT 11020 & 11021
 PT NE 1/4
 Addl.TieBack:

COMMERCIAL PROPERTY RECORD CARD

CLARK COUNTY

Situs : 330 S BURNETT RD

Parcel Id: 340-07-00022-206-1060

LUC: 710-SECTION 3735.67 - CRA

Card: 3 of 5

Tax Year: 2025

Printed: 04/01/26

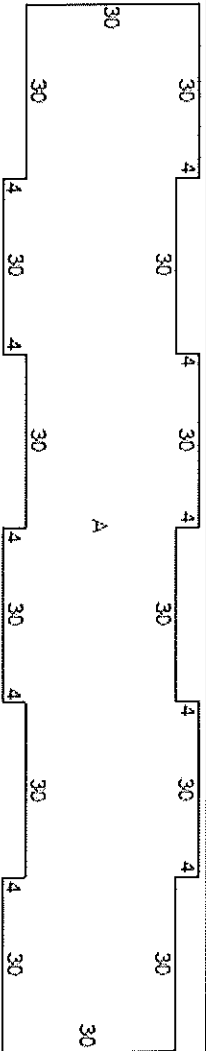

ID	Code	Description	Area
A	011	APARTMENT	5400
B	RA1	GARAGE-ATTACHED-FRM	308*
C	PR1	PORCH, OPEN	119*
D	PR1	PORCH, OPEN	192*

Additional Property Photos

COMMERCIAL PROPERTY RECORD CARD

CLARK COUNTY

Situs : 330 S BURNETT RD

Parcel Id: 340-07-00022-206-1060

LUC: 710-SECTION 3735.67 - CRA

Card: 3 of 5

Tax Year: 2025

Printed: 04/01/26

Income Detail (Includes all Buildings on Parcel)

Use Mod Grp Type	Inc Mod Description	Units	Net Area	Income Rate	Econ Adjust	Potential Gross Income	Vac Model	Vac Adj	Additional Income	Effective Gross Income	Expense Model %	Expense Adj %	Expense Adj	Other Expenses	Total Expenses	Net Operating Income
01	A 133	01-Apartment Unit	0	45,000			5		0							35

Line	Use Type	Per Bldg	Beds	Baths	Other	Units	Rent	Income
------	----------	----------	------	-------	-------	-------	------	--------

Building Cost Detail - Building 3 of 5

Total Gross Building Area	21,600
Replace, Cost New Less Depr	510,940
Percent Complete	100
Number of Identical Units	4
Economic Condition Factor	2,043,760
Final Building Value	1,0000
NBHD Fact	
Value per SF	94.62

Notes - Building 3 of 5

Income Summary (Includes all Building on Parcel)

Total Gross Rent Area	45,000
Total Gross Building Area	45,000

Misc & Gross Building Values

Misc Building No	
Gross Building:	Misc Adjusted Value

COMMERCIAL PROPERTY RECORD CARD

CLARK COUNTY

Situs : 330 S BURNETT RD Map ID: 340-07-00022-206-1060

LUC: 710-SECTION 3735.67 - CRA

Card: 4 of 5

Tax Year: 2025

Printed: 04/01/26

CURRENT OWNER	GENERAL INFORMATION
COMMUNITY GARDENS LP	Routing No. 0022-03 037-00 Class E Living Units 50 Neighborhood 340C1000 Alternate Id District Zoning CAUV
Field Review Flag:	

Property Notes
 ABATEMENT (2019-2033) 100% BLDG ONLY Note Codes:
 TY19NC-NEW APT BLDGS 100% COMPLETE AB-Abatement

Type	Rate	Size	Influence Factors	Infl %	Value
Land Information					
Total Acres: 6.7 Legal Acres: 6.7					

Assessment Information					
	Assessed	Appraised	Cost	Income	Market
Land	0	0	0	0	0
Building	1,507,640	4,307,550	4,307,550	0	0
Total	1,507,640	4,307,550	4,307,550	0	0
Value Flag 1-COST APPROACH Manual Override Reason Base Date of Value Effective Date of Value					

Entrance Information			
Date	ID	Entry Code	Source
06/06/19	KAR	2-Information At Door	4-Employee
06/01/18	KAR	2-Information At Door	3-Other

Permit Information			
Date Issued	Number	Price Purpose	Note
06/28/17		NEW HOME	13 Permits For New Dwellings/MClosed Permit

Sales/Ownership History			
Transfer Date	Price	Type	Validity
08/18/17	100,000		
08/18/17	100,000		

Deed Reference			
Deed Reference	Deed Type	Grantor	
WD-General Warranty Deed		NEIGHBORHOOD HOUSING PARTNERSH	
		NEIGHBORHOOD HOUSING PARTNERSH	

Property Factors
 Topo: 2-Above Street
 Utilities: 1-All Public
 Street/Road: 1-Paved 5-Sidewalk
 Traffic: 3-Heavy
 Location:
 Spot Loc:

Legal Description
 Parcel TieBack: 3400700022206060 Addl.TieBack:
 Range - Township - Section: - - -
 Legal Descriptions:
 GRANDVIEW PT 11020 & 11021
 PT NE 1/4

COMMERCIAL PROPERTY RECORD CARD

CLARK COUNTY

Situs : 330 S BURNETT RD

Parcel Id: 340-07-00022-206-1060

LUC: 710-SECTION 3735.67 - CRA

Card: 4 of 5

Tax Year: 2025

Printed: 04/01/26

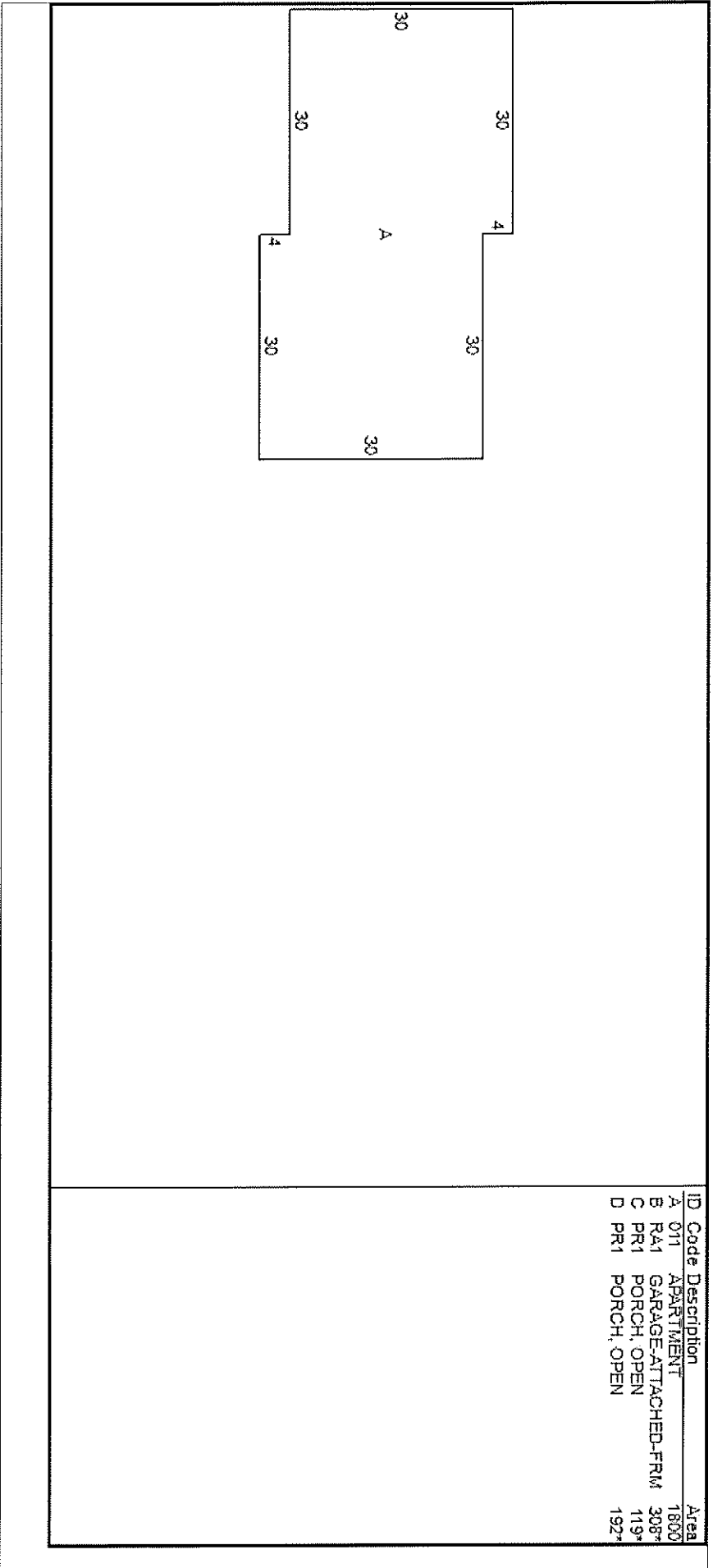

Additional Property Photos

COMMERCIAL PROPERTY RECORD CARD

CLARK COUNTY

Situs : 330 S BURNETT RD

Parcel Id: 340-07-00022-206-1060

LUC: 710-SECTION 3735.67 - CRA

Card: 4 of 5

Tax Year: 2025

Printed: 04/01/26

Income Detail (Includes all Buildings on Parcel)

Use Mod Grp Type	Inc Mod Description	Units	Net Area	Income Rate	Econ Adjust	Potential Gross Income	Vac Model	Vac Adj	Additional Income	Effective Gross Income	Expense Model %	Expense Adj %	Expense Adj	Other Expenses	Total Expenses	Net Operating Income
01	A 133	01-Apartment Unit	0	45,000			5		0							35

Apartment Detail - Building 4 of 5

Line	Use Type	Per Bldg	Beds	Baths	Other	Units	Rent	Income
------	----------	----------	------	-------	-------	-------	------	--------

Building Cost Detail - Building 4 of 5

Total Gross Building Area	5,400
Replace, Cost New Less Depr	174,430
Percent Complete	100
Number of Identical Units	3
Economic Condition Factor	523,290
Final Building Value	1,0000
NBHD Fact	
Value per SF	96.91

Notes - Building 4 of 5

Income Summary (Includes all Building on Parcel)

Total Gross Rent Area	45,000
Total Gross Building Area	45,000

Misc & Gross Building Values

Misc Building No	
Gross Building:	Misc Adjusted Value

COMMERCIAL PROPERTY RECORD CARD

CLARK COUNTY

Situs : 330 S BURNETT RD

Map ID: 340-07-00022-206-1060

LUC: 710-SECTION 3735.67 - CRA

Card: 5 of 5

Tax Year: 2025

Printed: 04/01/26

CURRENT OWNER	GENERAL INFORMATION
COMMUNITY GARDENS LP	Routing No. 0022-03 037-00 Class E Living Units 50 Neighborhood 340C1000 Alternate Id District Zoning CAUV
Field Review Flag:	

Property Notes
 ABATEMENT (2019-2033) 100% BLDG ONLY
 TY19NC-NEW APT BLDGS 100% COMPLETE
 Note Codes:
 AB-Abatement

Type	Rate	Size	Influence Factors	Infl %	Value
Land Information					
Total Acres: Legal Acres: 6.7					

Assessment Information					
Assessed	Appraised	Cost	Income	Market	
Land 0	0	0	0	0	0
Building 1,507,640	4,307,550	4,307,550	0	0	0
Total 1,507,640	4,307,550	4,307,550	0	0	0
Value Flag 1-COST APPROACH					
Manual Override Reason Base Date of Value Effective Date of Value					

Date	ID	Entry Code	Source
06/06/19	KAR	2-Information At Door	4-Employee
06/01/18	KAR	2-Information At Door	3-Other

Date Issued	Number	Price Purpose	Note	Status
06/28/17		NEW HOME	13 Permits For New Dwellings/MClosed Permit	

Transfer Date	Price	Type	Validity	Sales/Ownership History	Deed Reference	Deed Type	Grantor
08/18/17	100,000						NEIGHBORHOOD HOUSING PARTNERSH
08/18/17	100,000						WD-General Warranty Deed NEIGHBORHOOD HOUSING PARTNERSH

Property Factors
 Topo: 2-Above Street
 Utilities: 1-All Public
 Street/Road: 1-Paved
 Traffic: 3-Heavy
 Location:
 Spot Loc:

Legal Description
 Parcel TieBack: 3400700022206060
 Range - Township - Section: - -
 Legal Descriptions:
 GRANDVIEW PT 11020 & 11021
 PT NE 1/4
 Addl. TieBack:

COMMERCIAL PROPERTY RECORD CARD

CLARK COUNTY

Situs : 330 S BURNETT RD

Parcel Id: 340-07-00022-206-1060

LUC: 710-SECTION 3735.67 - CRA

Card: 5 of 5

Tax Year: 2025

Printed: 04/01/26

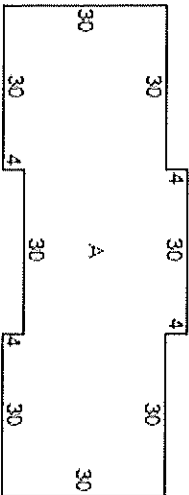

ID	Code	Description	Area
A	011	APARTMENT	2700
B	RA1	GARAGE-ATTACHED-FRM	308*
C	PR1	PORCH, OPEN	119*
D	PR1	PORCH, OPEN	192*

Additional Property Photos

COMMERCIAL PROPERTY RECORD CARD

CLARK COUNTY

Status : 330 S BURNETT RD

Parcel Id: 340-07-00022-206-1060

LUC: 710-SECTION 3735.67 - CRA

Card: 5 of 5

Tax Year: 2025

Printed: 04/01/26

Income Detail (Includes all Buildings on Parcel)

Use Mod Grp Type	Inc Mod Description	Model	Units	Net Area	Income Rate	Econ Adjust	Potential Gross Income	Vac Model	Vac Adj	Additional Income	Effective Gross Income	Expense Model %	Expense Adj %	Expense Adj	Other Expenses	Total Expenses	Net Operating Income
01 A	133	01-Apartment Unit	0	45,000				5		0							35

Apartment Detail - Building 5 of 5

Line	Use Type	Per Bldg	Beds	Baths	Other	Units	Rent	Income
------	----------	----------	------	-------	-------	-------	------	--------

Building Cost Detail - Building 5 of 5

Total Gross Building Area	10,800
Replace, Cost New Less Depr	259,930
Percent Complete	100
Number of Identical Units	4
Economic Condition Factor	
Final Building Value	1,039,720
NBHD Fact	1,0000
Value per SF	96.27

Notes - Building 5 of 5

Income Summary (Includes all Building on Parcel)

Total Gross Rent Area	45,000
Total Gross Building Area	45,000

Misc & Gross Building Values

Misc Building No	
Gross Building:	Misc Adjusted Value