

MAR 19 2026

HILLARY HAMILTON  
AUDITOR

Tax year 2025 BOR no. 2025-135  
County Clark Date received 3/19/2026

DTE 1  
Rev. 12/22

**Complaint Against the Valuation of Real Property**

Answer all questions and type or print all information. Read instructions on back before completing form.  
Attach additional pages if necessary.

This form is for full market value complaints only. All other complaints should use DTE Form 2

Original complaint  Counter complaint  
Notices will be sent only to those named below.

Name		Street address, City, State, ZIP code	
1. Owner of property	DAVID & VICKI L. HARTLEY		2242 N FOUNTAIN, SPFLD, OH 45504
2. Complainant if not owner			
3. Complainant's agent			
4. Telephone number and email address of contact person 937-399-6626			
5. Complainant's relationship to property, if not owner If more than one parcel is included, see "Multiple Parcels" Instruction.			
6. Parcel numbers from tax bill		Address of property	
340-07-00036-101-001		2242 N FOUNTAIN BND, SPFLD, OH 45504	
340-07-00036-101-002			
340-07-00036-101-003			
7. Principal use of property			
8. The increase or decrease in market value sought. Counter-complaints supporting auditor's value may have -0- in Column C.			
Parcel number	Column A Complainant's Opinion of Value (Full Market Value)	Column B Current Value (Full Market Value)	Column C Change in Value
-001		17,540	
-002	317,250.00	39,190	106,730
-003		14,520	
9. The requested change in value is justified for the following reasons: MARKET APPRAISAL			

10. Was property sold within the last three years?  Yes  No  Unknown If yes, show date of sale \_\_\_\_\_

and sale price \$ \_\_\_\_\_ ; and attach information explained in "Instructions for Line 10" on back.

11. If property was not sold but was listed for sale in the last three years, attach a copy of listing agreement or other available evidence.

12. If any improvements were completed in the last three years, show date N/A and total cost \$ \_\_\_\_\_

13. Do you intend to present the testimony or report of a professional appraiser?  Yes  No  Unknown

14. If you have filed a prior complaint on this parcel since the last reappraisal or update of property values in the county, the reason for the valuation change requested must be one of those below. Please check all that apply and explain on attached sheet. See R.C. section 5715.19(A)(2) for a complete explanation.

- The property was sold in an arm's length transaction.
- A substantial improvement was added to the property.
- The property lost value due to a casualty.
- Occupancy change of at least 15% had a substantial economic impact on my property.

15. If the complainant is a legislative authority and the complaint is an original complaint with respect to property not owned by the complainant, R.C. 5715.19(A)(8) requires this section to be completed.

- The complainant has complied with the requirements of R.C. section 5715.19(A)(6)(b) and (7) and provided notice prior to the adoption of the resolution required by division (A)(6)(b) of that section as required by division (A)(7) of that section.

I declare under penalties of perjury that this complaint (including any attachments) has been examined by me and to the best of my knowledge and belief is true, correct and complete.

Date FEB 27, 2026 Complainant or agent (printed) DAVID HARTLEY Title (if agent) \_\_\_\_\_

Complainant or agent (signature) David Hartley

Sworn to and signed in my presence, this Feb 27, 2026 day of February 2026  
(Date) (Month) (Year)

Notary Richard A. Spencer

Richard A. Spencer  
my Commission has  
No expiration date  
Attorney-at-Law

APPROVED  
Clark County Tax Map

CLARK COUNTY, OHIO

COMBINATION OF PARCELS

SEP 29 2025

Date: 9-29-25

- Legal Description
- Survey Plat/Lotsplit
- Subdivision/Annexation

TO: Clark County Tax Map Department

FROM: Property Owner

*\*PLEASE CONSULT YOUR LOCAL PLANNING AUTHORITY ON ZONING REGULATIONS PRIOR TO REQUESTING A PARCEL COMBINATION\**

SUBJECT: Combination of Lot Parcel

I / We, DAVID AND VICKI L. HARTLEY being the Present owner(s) of Permanent Parcel No.

340-07-00036-101-001

I / We hereby request the Clark County Tax Map Department, to combine the said Parcel with the adjoining tract which

I / We also own which is known as Permanent Parcel No.

340-07-00036-101-002

Signed:

David Hartley

Vicki Hartley

(Present property owner(s))

Phone Number or Email address: 937-399-6626

Additional Parcel numbers: (List below)

340-07-00036-101-003

Treasurer Certified current on Property Taxes: (current tax sheet must be attached)

Real Estate property tax changes checked \_\_\_\_\_

*Pd  
09/29/25  
SMC/aw*



ROGER SEE, Broker  
411 Central Ave.  
Springfield, OH 45505

BUS 937-322-4996  
OFF 937-606-3984

Date NOV. 6, 2025

Property Address 2242 N FOUNTAIN BLVD  
SPRINGFIELD, OH.

Re Market Appraisal For  
DAVID and DICKIE HARTLEY

**TO WHOM IT MAY CONCERN**

This is to certify that I am a licensed Broker in the State of Ohio and I have been a practicing Broker in Springfield, Ohio for 55 years. I have completed all the educational requirements as set by the State.

I have personally inspected the above captioned real property and find it to have a value of  
\$ 317,250.00

If further is required, please advise.

Sincerely,

*Roger A See*

Roger A. See, Broker  
166721

Appraisal Fee \_\_\_\_\_

# Comparable Properties

	Subject		1041917		1041275		1040929	
	2242 N Fountain Ave SPRINGFIELD Ohio 45504		2002 N Fountain Boulevard Springfield OH		259 N Broadmoor Boulevard Springfield OH		2215 N Fountain Boulevard Springfield OH	
Distance From Subject								
List Price				0.84		0.87		0.91
Original List Price				\$399,000		\$275,000		\$325,000
Sold Price				\$399,000		\$275,000		\$375,000
Status				Active		Contingency - Finance and Inspections		Active
Status Date				10/10/2025		10/10/2025		08/24/2025
Days on Market				27		58		74
Cumulative Days on Market				26		56		73
Adjustment				+/-		+/-		+/-
Total Bedrooms	3		3		3		4	
Total Baths	2		3		3		3	
Total Square Footage	3,408		2,464		1,612		1,956	
Lot Dimensions			1tr		63 X 138		66X249	
Acres			0.21		0.2		0.38	
Year Built	1958		1929		1930		1922	
Zip + 4	45504							
Adjusted Price	\$317,250		\$399,000		\$275,000		\$325,000	

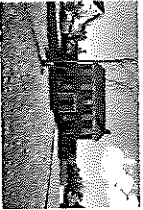

10:00am PHONE CALL

**INFORMAL HEARING REVIEW**

Clark County Auditor's Office 2025 reappraisal Review

**Property Owner**

**Auditor's Office Representative**

Please complete the following:

Today's Date: 10/10/2025

Phone# 937-399-6626 / 937-215-8770  
Home cell

Email Address: \_\_\_\_\_

Name that appears on the Value Change Notice:

David & Vicki L Hartley

Property Address: 2412 North Fountain Boulevard

Parcel Number(s) as it appears on the Value Change Notice:

340-07-00036-101-001 ; -002 ; -003

Briefly explain your reason for this visit: \_\_\_\_\_

\*\* We will NOT know the 'Real Estate Tax' amounts until we receive the rates from the Dept. of Taxation later in December.

Any new levies that are voted on can also effect the tax rates in each Taxing District.

Reviewer: Gary

Discussion Topic(s)

- Land
- Buildings
- Total Value
- General Discussion Only

Important details of this meeting (use back if needed):

Bad Tract / Bathroom are Deleted  
Kitchen is original / Inseted Bad is not used  
last 20 years / market is bad  
\$

**ACTION:**

- None Required
- Data Entry Change (detail) Lines of All Grade E - %comp 5% / EC: 108810
- Field Check For (detail) \_\_\_\_\_
- Review (detail) \_\_\_\_\_

COMPLETION: (this section MUST be completed)

- All Review Complete per Appraiser
- Data Entered in System

\$ 391,920

59  
KJE

As this is an "informal" process we can NOT guarantee any changes will be made. We CAN guarantee, however, that we will hear and take into full consideration any and all issues you present. If a change in your favor is warranted it will reflect on our website by the end of November and reflect on your next tax bill in January 2025. Due to time constraints we will NOT be contacting you individually. Thank you in advance for your understanding of this tedious process.

## Phone Call

---

From Vicki Hartley <vh2242@gmail.com>

Date Thu 10/9/2025 12:30 PM

To Gray, Shayne <sgray@clarkcountyohio.gov>

You don't often get email from vh2242@gmail.com. [Learn why this is important](#)

Sorry we had to cancel our appointment today.

We will be available tomorrow after 10:00 am for your call. Our home phone number is 937/399-6626. My mobile phone number listed with your office is 937/215-8770.

Thanks,

Dave and Vicki Hartley

**RESIDENTIAL PROPERTY RECORD CARD**

CLARK COUNTY

Situs : 2242 N FOUNTAIN BLVD

Map ID: 340-07-00036-101-002

LUC: 510-SINGLE FAMILY, PLATTED

Card: 1 of 1

Tax Year: 2025

Printed: 10/09/25

**CURRENT OWNER**

HARTLEY DAVID & VICKI L

**GENERAL INFORMATION**

Routing No. 0036-04 002-00  
 Class Residential  
 Living Units 1  
 Neighborhood 340R0042  
 District  
 Zoning  
 Alternate Id  
 Tax District Springfield Corp. Scsd

CAUV

Field Review Flag:

**Property Notes**

Note Codes:



3400700036101002 12/12/2023

**Land Information**

Type	Size	Influence Factors	Influence %	Value
F-Regular Lot	F 69 180	2-Excessive Fr	-20	34,840

Total Acres: .2851

Legal Acres: 0.0000

NBHD Fact: 1.0000

**Assessment Information**

	Assessed	Appraised	Cost	Income	Market
Land	12,190	34,840	34,840	0	34,840
Building	150,770	430,770	430,770	0	254,490
Total	162,960	465,610	465,610	0	289,330

Value Flag 1-COST APPROACH

Manual Override Reason  
 Base Date of Value  
 Effective Date of Value  
 Owner Occupied Y

**Entrance Information**

Date	ID	Entry Code	Source
04/23/24	LB	10-Adv	3-Other
06/08/18	GBL	R-Review	3-Other
11/01/17	AGS	10-Adv	3-Other
08/31/11	DWP	7-Quallity Check	3-Other
08/22/11	ABC	5-Occupant Not Home	3-Other

**Sales/Ownership History**

Transfer Date	Price	Type	Validity	Deed Reference	Deed Type	Grantor
07/26/93						HARTLEY DAVID
12/31/87						

**Property Factors**

Topo: 1-Level  
 Utilities: 1-All Public  
 Street/Road: 1-Paved  
 Traffic: 3-Heavy

5-Sidewalk

**Legal Description**

Parcel Tieback: 3400700036101001  
 Range - Township - Section: - -  
 Legal Descriptions:  
 COUNTRY CLUB DISTRICT SUBDVN  
 12947

Addl. Tieback:

**RESIDENTIAL PROPERTY RECORD CARD**

CLARK COUNTY

Situs : 2242 N FOUNTAIN BLVD Parcel Id: 340-07-00036-101-002

LUC: 510-SINGLE FAMILY, PLATTED L1 Card: 1 of 1 Tax Year: 2025 Printed: 10/09/25

**Dwelling Information**

Story height	1	Total Rooms	8
Exterior Walls	7-Slone	Bedrooms	3
Style	03-Ranch	Family Rooms	1
Year Built	1958	Full Baths	2
Eff Year Built		Half Baths	1
Year Remodeled		Addl. Fixtures	2
Kitchen Remod		Total Fixtures	10
Bath Remod			
Basement	3-Part Bsmt		

Heat Type	3-Central Heat W/ Ac	Masonry Trim	
Fuel Type	2-Gas	Unfinished Area	
System Type	1-Hot/Air	Rec Rm Size	
Attic	1-None	FB/LA Size	
Phy. Condition	A-Average Condition	Openings	2
Int vs Ext	2-Same	# Car Bsmt Gar	
Stacks	2		
Pre-Fab			

Misc		Qty	
Grade	B		
CDU	GD-GOOD	Functional	
Market Adj		Economic	
% Complete	0	% Good Ovr	
Cost & Design	0	NBHD Fact	1

**Dwelling Computations**

Base Price	498,930	% Good	66
Plumbing	9,100	Market Adj	
Basement	-13,430	Functional	
Heating	16,750	Economic	
Attic	0	% Complete	
Other Features	17,539	C&D Factor	1
Subtotal	528,890	Adj Factor	1
		Additions	81,700
Ground Floor Area	3,408		
Total Living Area	3,408	Dwelling Value	430,770

**Misc & Gross Building Values**

Misc Building No		Misc Adjusted Value	
Gross Building:			

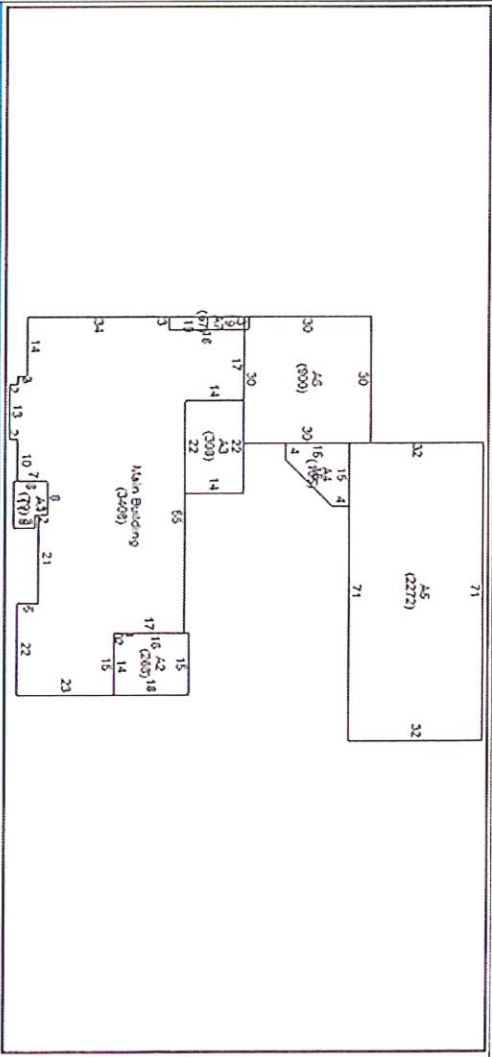

Line	Low	1st	2nd	3rd	Area	Gr	Qty	ModCd	PH	FV	MA	%Comp	Value
0					3,408								5,000
1		2			79								15,100
2		1			268								17,300
3		1			308								1,300
4		26			165								128,800
5		4			2,272				D-	V-			42,300
6		S9M			900								3,600
7		2			57								

**Outbuilding Data**

Type	Yr Bit	Eff Yr	Size	Area	Gr	Qty	ModCd	PH	FV	MA	%Comp	Value

**Condominium / Mobile Home Information**

Complex Name		Number	
Condo Model		Unit Type	
Unit Number		Unit View	
Unit Level		Model (MH)	
		Model Make (MH)	

RESIDENTIAL PROPERTY RECORD CARD

1:20

CLARK COUNTY

Situs : 2242 N FOUNTAIN BLVD

Map ID: 340-07-00036-101-001

LUC: 500-RESIDEN VAC, PLATTED V

Card: 1 of 1

Tax Year: 2025

Printed: 10/09/25

CURRENT OWNER

HARTLEY DAVID & VICKIL

GENERAL INFORMATION

Routing No. 0036-04 001-00  
 Class Residential  
 Living Units 340R0042  
 Neighborhood District  
 Zoning  
 Alternate Id  
 Tax District Springfield Corp. Scsd

CAUV  
 Field Review Flag:

Property Notes

Note Codes:



Land Information

Type	Size	Influence Factors	Influence %	Value
F-Undeveloped Lot	F 70 180	2-Excessive Fr	-20	17,540

Total Acres: .2893

Legal Acres: 0.0000

NBHD Fact: 1.0000

Assessment Information

	Assessed	Appraised	Cost	Income	Market
Land	6,140	17,540	17,540	0	0
Building	0	0	0	0	0
Total	6,140	17,540	17,540	0	0

Value Flag 1-COST APPROACH  
 Manual Override Reason  
 Base Date of Value  
 Effective Date of Value  
 Owner Occupied

Entrance Information

Date	ID	Entry Code	Source
04/23/24	LB	10-Adv	3-Other
06/08/18	GBL	R-Review	3-Other
08/22/11	ABC	0-Vac Or Oby Only	3-Other
02/17/06	PJ		

Sales/Ownership History

Transfer Date Price Type Validity

07/26/93  
 12/31/87

Deed Reference Deed Type

Grantor  
 HARTLEY DAVID

Property Factors

Topo: 1-Level  
 Utilities: 1-All Public  
 Street/Road: 1-Paved  
 Traffic: 3-Heavy  
 5-Sidewalk

Legal Description

Parcel Tieback: 3400700036101002  
 Range - Township - Section: - - -  
 Legal Descriptions:  
 COUNTRY CLUB DISTRICT SUBDVN  
 12946

Add. Tieback:

Permit Information

Date Issued Number Price Purpose Note Status

**RESIDENTIAL PROPERTY RECORD CARD**

CLARK COUNTY

Situs : 2242 N FOUNTAIN BLVD

Parcel Id: 340-07-00036-101-001

LUC: 500-RESIDEN VAC, PLATTED VAC

Card: 1 of 1

Tax Year: 2025

Printed: 10/09/25

**Dwelling Information**

Story height	Total Rooms
Exterior Walls	Bedrooms
Style	Family Rooms
Year Built	Full Baths
Eff Year Built	Half Baths
Year Remodeled	Addl. Fixtures
Kitchen Remod	Total Fixtures
Bath Remod	
Basement	
Heat Type	Masonry Trim
Fuel Type	Unfinished Area
System Type	Rec Rm Size
Attic	FBLA Size
Phy. Condition	Openings
Int vs Ext	# Car Bsmt Gar
Stacks	
Pre-Fab	
Misc	Qty
Grade B	
CDU GD-GOOD	
Market Adj	Functional
% Complete	Economic
Cost & Design 0	% Good Ovr
	NBHD Fact

**Dwelling Computations**

Base Price	% Good
Plumbing	Market Adj
Basement	Functional
Heating	Economic
Attic	% Complete
Other Features	C&D Factor
Subtotal	Adj Factor
	Additions
Ground Floor Area	Dwelling Value
Total Living Area	
Building Notes	

**Misc & Gross Building Values**

Misc Building No  
Gross Building:

Misc Adjusted Value

Line	Low	1st	2nd	3rd	Area	Yr Bit	Eff Yr	Grade	CDU	%Comp	Value
<b>Additions</b>											

**Outbuilding Data**

Type	Yr Bit	Eff Yr	Size	Area	Gr	Qty	ModCd	PH	FV	MA	%Comp	Value
------	--------	--------	------	------	----	-----	-------	----	----	----	-------	-------

**Condominium / Mobile Home Information**

Complex Name  
Condo Model  
Unit Number  
Unit Level

Number  
Unit Type  
Unit View  
Model (MH)  
Model Make (MH)

**RESIDENTIAL PROPERTY RECORD CARD**

**CLARK COUNTY**

Situs : 2242 N FOUNTAIN BLVD

Map ID: 340-07-00036-101-003

LUC: 500-RESIDEN VAC, PLATTED V

Card: 1 of 1

Tax Year: 2025

Printed: 10/09/25

**CURRENT OWNER**

HARTLEY DAVID & VICKIL

**GENERAL INFORMATION**

Routing No. 0036-04 003-00  
 Class Residential  
 Living Units  
 Neighborhood 340R0042  
 District  
 Zoning  
 Alternate Id  
 Tax District Springfield Corp. Secd

CAUV

Field Review Flag:

**Property Notes**

Note Codes:

**Land Information**

Type	Size	Influence Factors	Influence %	Value
F-Undeveloped Lot	F 45 180	2-Excessive Fr	-20	14,520

Total Acres: .186

Legal Acres: 0.0000

NBHD Fact: 1.0000

**Assessment Information**

	Assessed	Appraised	Cost	Income	Market
Land	5,080	14,520	14,520	0	0
Building	0	0	0	0	0
Total	5,080	14,520	14,520	0	0

Value Flag 1-COST APPROACH  
 Manual Override Reason  
 Base Date of Value  
 Effective Date of Value  
 Owner Occupied

**Entrance Information**

Date	ID	Entry Code	Source
04/23/24	LB	10-Adv	3-Other
06/08/18	GBL	R-Review	3-Other
08/22/11	ABC	0-Vac Or Oby Only	3-Other
02/17/06	PJ		

**Permit Information**

Date Issued	Number	Price	Purpose	Note	Status

**Sales/Ownership History**

Transfer Date	Price	Type	Validity	Deed Reference	Deed Type	Grantor
07/26/93						HARTLEY DAVID
12/31/87						

**Property Factors**

Topo: 1-Level  
 Utilities: 1-All Public  
 Street/Road: 1-Paved  
 Traffic: 3-Heavy  
 5-Sidewalk

**Legal Description**

Parcel Tieback:  
 Range - Township - Section: - -  
 Legal Descriptions:  
 COUNTRY CLUB DISTRICT SUBDVN N PT  
 12948  
 Addl. Tieback:

**RESIDENTIAL PROPERTY RECORD CARD**

CLARK COUNTY

Situs : 2242 N FOUNTAIN BLVD

Parcel Id: 340-07-00036-101-003

LUC: 500-RESIDEN VAC, PLATTED VAC

Card: 1 of 1

Tax Year: 2025

Printed: 10/09/25

**Dwelling Information**

Story height	Total Rooms
Exterior Walls	Bedrooms
Style	Family Rooms
Year Built	Full Baths
Eff Year Built	Half Baths
Year Remodeled	Addl. Fixtures
Kitchen Remod	Total Fixtures
Bath Remod	
Basement	
Heat Type	Masonry Trim
Fuel Type	Unfinished Area
System Type	Rec Rm Size
Attic	FBLA Size
Phy. Condition	Openings
Int vs Ext	# Car Bsmt Gar
Stacks	
Pre-Fab	
Misc	Qty
Grade B	
CDU GD-GOOD	
Market Adj	Functional
% Complete	Economic
Cost & Design 0	% Good Ovr
	NBHD Fact

**Dwelling Computations**

Base Price	% Good
Plumbing	Market Adj
Basement	Functional
Heating	Economic
Attic	% Complete
Other Features	C&D Factor
Subtotal 0	Adj Factor
	Additions
Ground Floor Area	Dwelling Value
Total Living Area	
Building Notes	

**Misc & Gross Building Values**

Misc Building No  
Gross Building:

Misc Adjusted Value

Line	Low	1st	2nd	3rd	Area	Yr Bilt	Eff Yr	Grade	CDU	%Comp	Value
<b>Additions</b>											

**Outbuilding Data**

Type	Yr Bilt	Eff Yr	Size	Area	Gr	Qty	ModCd	PH	FV	MA	%Comp	Value
------	---------	--------	------	------	----	-----	-------	----	----	----	-------	-------

**Condominium / Mobile Home Information**

Complex Name  
Condo Model  
Unit Number  
Unit Level

Number  
Unit Type  
Unit View  
Model (MH)  
Model Make (MH)

**RESIDENTIAL PROPERTY RECORD CARD**

CLARK COUNTY

Situs : 2242 N FOUNTAIN BLVD

Map ID: 340-07-00036-101-001

LUC: 500-RESIDEN VAC, PLATTED V

Card: 1 of 1

Tax Year: 2025

Printed: 03/25/26

**CURRENT OWNER**

HARTLEY DAVID & VICKI L

**GENERAL INFORMATION**

Routing No. 0036-04 001-00  
 Class Residential  
 Living Units  
 Neighborhood 340R0042  
 District  
 Zoning  
 Alternate Id  
 Tax District Springfield Corp. Scsd

CAUV

Field Review Flag:

**Property Notes**

Note Codes:

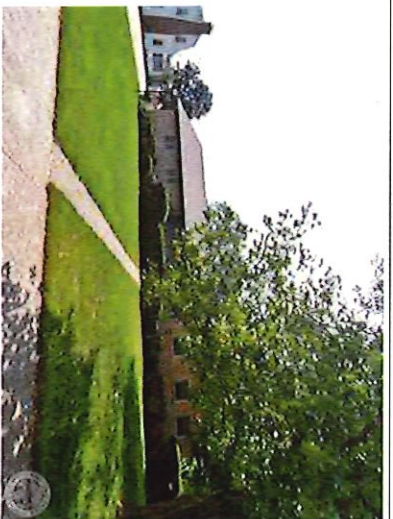

**Land Information**

Type	Size	Influence Factors	Influence %	Value
F-Undeveloped Lot	F 70 180	2-Excessive Fr	-20	17,540

Total Acres: .2893

Legal Acres: 0.0000

NBHD Fact: 1.0000

**Assessment Information**

	Assessed	Appraised	Cost	Income	Market
Land	6,140	17,540	17,540	0	0
Building	0	0	0	0	0
Total	6,140	17,540	17,540	0	0

Value Flag 1-COST APPROACH  
 Manual Override Reason  
 Base Date of Value  
 Effective Date of Value  
 Owner Occupied

**Entrance Information**

Date	ID	Entry Code	Source
04/23/24	LB	10-Adv	3-Other
06/08/18	GBL	R-Review	3-Other
08/22/11	ABC	0-Vac Or Obv Only	3-Other
02/17/06	PJ		

**Permit Information**

Date Issued	Number	Price	Purpose	Note	Status

**Sales/Ownership History**

Deed Reference	Deed Type	Grantor
340/5327		HARTLEY DAVID

Transfer Date

07/26/93  
12/31/87

Price Type

Validity

**Property Factors**

Topo: 1-Level  
 Utilities: 1-All Public  
 Street/Road: 1-Paved  
 Traffic: 3-Heavy

5-Sidewalk

**Legal Description**

Parcel Tieback: 3400700036101002  
 Range - Township - Section: - -  
 Legal Descriptions:  
 COUNTRY CLUB DISTRICT SUBDVN  
 12946

Addl. Tieback:

**RESIDENTIAL PROPERTY RECORD CARD**

**CLARK COUNTY**

Situs : 2242 N FOUNTAIN BLVD Parcel Id: 340-07-00036-101-001

LUC: 500-RESIDEN VAC, PLATTED VAC Card: 1 of 1 Tax Year: 2025 Printed: 03/25/26

**Dwelling Information**

Story height	Total Rooms
Exterior Walls	Bedrooms
Style	Family Rooms
Year Built	Full Baths
Eff Year Built	Half Baths
Year Remodeled	Addl. Fixtures
Kitchen Remod	Total Fixtures
Bath Remod	
Basement	
Heat Type	Masonry Trim
Fuel Type	Unfinished Area
System Type	Rec Rm Size
Attic	FBLA Size
Phy. Condition	Openings
Int vs Ext	# Car Bsmnt Gar
Stacks	
Pre-Fab	
Misc	Qty
Grade B	
CDU GD-GOOD	
Market Adj	Functional
% Complete	Economic
Cost & Design 0	% Good Ovr
	NBHD Fact

**Dwelling Computations**

Base Price	% Good
Plumbing	Market Adj
Basement	Functional
Heating	Economic
Attic	% Complete
Other Features	C&D Factor
Subtotal	Adj Factor
	Additions
Ground Floor Area	Dwelling Value
Total Living Area	
Building Notes	

**Misc & Gross Building Values**

Misc Building No	Misc Adjusted Value
Gross Building:	

**Additions**

Line	Low	1st	2nd	3rd	Area	Yr Bit	Eff Yr	Grade	CDU	%Comp	Value
------	-----	-----	-----	-----	------	--------	--------	-------	-----	-------	-------

**Outbuilding Data**

Type	Yr Bit	Eff Yr	Size	Area	Gr	Qty	ModCd	PH	FV	MA	%Comp	Value
------	--------	--------	------	------	----	-----	-------	----	----	----	-------	-------

**Condominium / Mobile Home Information**

Complex Name	Number
Condo Model	Unit Type
Unit Number	Unit View
Unit Level	Model (MH)
	Model Make (MH)

**RESIDENTIAL PROPERTY RECORD CARD**

**CLARK COUNTY**

Situs : 2242 N FOUNTAIN BLVD

Map ID: 340-07-00036-101-002

LUC: 510-SINGLE FAMILY, PLATTED

Card: 1 of 1

Tax Year: 2025

Printed: 03/25/26

**CURRENT OWNER**

HARTLEY DAVID & VICKI L

**GENERAL INFORMATION**

Routing No. 0036-04 002-00  
 Class Residential  
 Living Units 1  
 Neighborhood 340R0042  
 District  
 Zoning  
 Alternate Id  
 Tax District Springfield Corp. Scsd

CAUV

Field Review Flag:

**Property Notes**

Note Codes:



3400700036101002 12/12/2023

**Land Information**

Type	Size	Influence Factors	Influence %	Value
F-Regular Lot	F 69 180	2-Excessive Fr	-20	34,840

Total Acres: .2851

Legal Acres: 0.0000

NBHD Fact: 1.0000

**Assessment Information**

	Assessed	Appraised	Cost	Income	Market
Land	12,190	34,840	34,840	0	34,840
Building	124,980	357,080	357,080	0	303,870
<b>Total</b>	<b>137,170</b>	<b>391,920</b>	<b>391,920</b>	<b>0</b>	<b>338,710</b>

Value Flag 1-COST APPROACH  
 Manual Override Reason  
 Base Date of Value  
 Effective Date of Value  
 Owner Occupied Y

**Entrance Information**

Date	ID	Entry Code	Source
04/23/24	LB	10-Adv	3-Other
06/08/18	GBL	R-Review	3-Other
11/01/17	AGS	10-Adv	3-Other
08/31/11	DWP	7-Quality Check	3-Other
08/22/11	ABC	5-Occupant Not Home	3-Other

**Sales/Ownership History**

Deed Reference	Deed Type	Grantor
340/5327		HARTLEY DAVID

**Property Factors**

Topo: 1-Level  
 Utilities: 1-All Public  
 Street/Road: 1-Paved  
 Traffic: 3-Heavy

5-Sidewalk

**Legal Description**

Parcel Tieback: 3400700036101001  
 Range - Township - Section: - -  
 Legal Descriptions:  
 COUNTRY CLUB DISTRICT SUBDVN  
 12947

Addl. Tieback:

Validity

Price Type

Transfer Date

07/26/93  
 12/31/87

**RESIDENTIAL PROPERTY RECORD CARD**

**CLARK COUNTY**

Situs : 2242 N FOUNTAIN BLVD

Parcel Id: 340-07-00036-101-002

LUC: 510-SINGLE FAMILY, PLATTED L

Card: 1 of 1

Tax Year: 2025

Printed: 03/25/26

**Dwelling Information**

Story height 1  
 Exterior Walls 7-Stone  
 Style 03-Ranch  
 Year Built 1958  
 Eff Year Built  
 Year Remodeled  
 Kitchen Remod  
 Bath Remod  
 Basement 3-Part Bsmt

Total Rooms 8  
 Bedrooms 3  
 Family Rooms 1  
 Full Baths 2  
 Half Baths 1  
 Addl. Fixtures 2  
 Total Fixtures 10

Heat Type 3-Central Heat W/ Ac  
 Fuel Type 2-Gas  
 System Type 1-Hot/Air  
 Attic 1-None  
 Phy. Condition A-Average Condition  
 Int vs Ext 2-Same

Masonry Trim  
 Unfinished Area  
 Rec Rm Size  
 FBLA Size

Stacks 2  
 Pre-Fab  
 Misc Qty  
 Openings 2  
 # Car Bsmt Gar

Grade B  
 CDU GD-GOOD  
 Market Adj  
 % Complete  
 Cost & Design 0

Functional  
 Economic 88  
 % Good Ovr  
 NBHD Fact 1

**Dwelling Computations**

Base Price 498,930  
 Plumbing 9,100  
 Basement -13,430  
 Heating 16,750  
 Attic 0  
 Other Features 17,539  
 Subtotal 528,890  
 Ground Floor Area 3,408  
 Total Living Area 3,408  
 Dwelling Value 357,080  
 Building Notes

**Misc & Gross Building Values**

Misc Building No  
 Gross Building:  
 Misc Adjusted Value

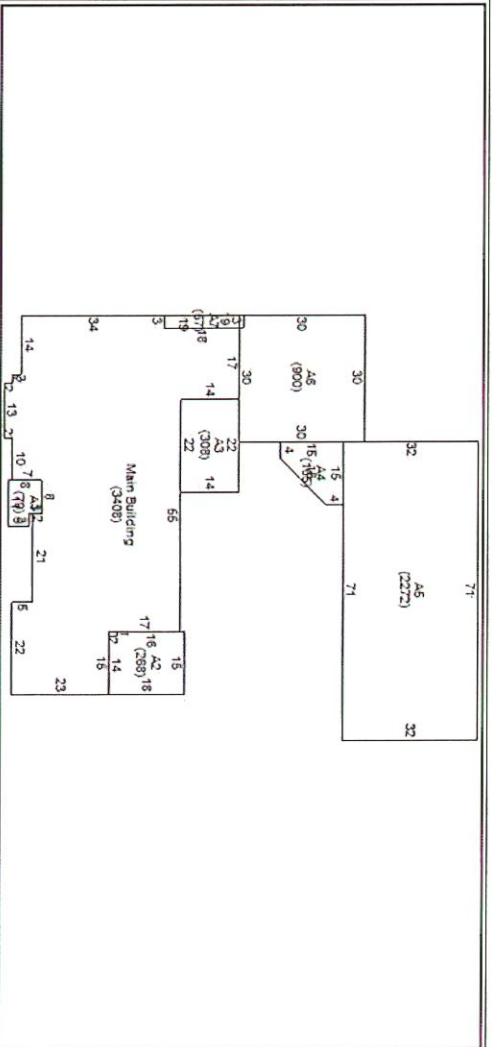

**Additions**

Line	Low	1st	2nd	3rd	Area	Yr	Bit	Eff	Yr	Grade	CDU	%Comp	Value
0					3,408								
1		2			79								5,000
2		1			268								15,100
3		1			308								17,300
4		26			165								1,300
5		4			2,272					E-	V-	5	77,300
6					900								42,300
7					57								3,600

**Outbuilding Data**

Type	Yr	Bit	Eff	Yr	Size	Area	Gr	Qty	Mod	Cd	PH	FV	MA	%Comp	Value
------	----	-----	-----	----	------	------	----	-----	-----	----	----	----	----	-------	-------

**Condominium / Mobile Home Information**

Complex Name  
 Condo Model  
 Unit Number  
 Unit Level  
 Number  
 Unit Type  
 Unit View  
 Model (MH)  
 Model Make (MH)

**RESIDENTIAL PROPERTY RECORD CARD**

CLARK COUNTY

Stus : 2242 N FOUNTAIN BLVD

Map ID: 340-07-00036-101-003

LUC: 500-RESIDEN VAC, PLATTED V

Card: 1 of 1

Tax Year: 2025

Printed: 03/25/26

**CURRENT OWNER**

HARTLEY DAVID & VICKI L

**GENERAL INFORMATION**

Routing No. 0036-04 003-00  
 Class Residential  
 Living Units  
 Neighborhood 340R0042  
 District  
 Zoning  
 Alternate Id  
 Tax District Springfield Corp. Scsd

CAUV

Field Review Flag:

**Property Notes**

Note Codes:

**Land Information**

Type	Size	Influence Factors	Influence %	Value
F-Undeveloped Lot	F 45 180	2-Excessive Fr	-20	14,520

Total Acres: .186

Legal Acres: 0.0000

NBHD Fact: 1.0000

**Assessment Information**

	Assessed	Appraised	Cost	Income	Market
Land	5,080	14,520	14,520	0	0
Building	0	0	0	0	0
<b>Total</b>	<b>5,080</b>	<b>14,520</b>	<b>14,520</b>	<b>0</b>	<b>0</b>

Value Flag 1-COST APPROACH  
 Manual Override Reason  
 Base Date of Value  
 Effective Date of Value  
 Owner Occupied

**Entrance Information**

Date	ID	Entry Code	Source
04/23/24	LB	10-Adv	3-Other
06/08/18	GBL	R-Review	3-Other
08/22/11	ABC	0-Vac Or Obv Only	3-Other
02/17/06	PJ		

**Sales/Ownership History**

Transfer Date	Price	Type	Validity	Deed Reference	Deed Type	Grantor
07/26/93						HARTLEY DAVID
12/31/87						

**Property Factors**

Topo: 1-Level  
 Utilities: 1-All Public  
 Street/Road: 1-Paved  
 Traffic: 3-Heavy  
 5-Sidewalk

**Legal Description**

Parcel Tieback:  
 Range - Township - Section: - -  
 Legal Descriptions:  
 COUNTRY CLUB DISTRICT SUBDVN N PT  
 12948  
 Addl. Tieback:

**RESIDENTIAL PROPERTY RECORD CARD**

**CLARK COUNTY**

Situs : 2242 N FOUNTAIN BLVD

Parcel Id: 340-07-00036-101-003

LUC: 500-RESIDEN VAC, PLATTED VAC

Card: 1 of 1

Tax Year: 2025

Printed: 03/25/26

**Dwelling Information**

Story height	Total Rooms
Exterior Walls	Bedrooms
Style	Family Rooms
Year Built	Full Baths
Eff Year Built	Half Baths
Year Remodeled	Addl. Fixtures
Kitchen Remod	Total Fixtures
Bath Remod	
Basement	

Heat Type	Masonry Trim
Fuel Type	Unfinished Area
System Type	Rec Rm Size
Attic	FBLA Size
Phy. Condition	Openings
Int vs Ext	# Car Bsmt Gar

Stacks  
Pre-Fab

Misc

Qty

Grade B  
CDU GD-GOOD  
Market Adj  
% Complete  
Cost & Design 0

Functional  
Economic  
% Good Ovr  
NBHD Fact

**Dwelling Computations**

Base Price	% Good
Plumbing	Market Adj
Basement	Functional
Heating	Economic
Attic	% Complete
Other Features	C&D Factor
Subtotal	Adj Factor
	Additions

Ground Floor Area  
Total Living Area

Dwelling Value

Building Notes

**Misc & Gross Building Values**

Misc Building No  
Gross Building:

Misc Adjusted Value

Line	Low	1st	2nd	3rd	Area	Yr Bit	Eff Yr	Grade	CDU	%Comp	Value
------	-----	-----	-----	-----	------	--------	--------	-------	-----	-------	-------

**Additions**

Type	Yr Bit	Eff Yr	Size	Area	Gr	Qty	ModCd	PH	FV	MA	%Comp	Value
------	--------	--------	------	------	----	-----	-------	----	----	----	-------	-------

**Outbuilding Data**

**Condominium / Mobile Home Information**

Complex Name  
Condo Model  
Unit Number  
Unit Level

Number  
Unit Type  
Unit View  
Model (MH)  
Model Make (MH)